



CREATIVE PLACES

City of Hobart Venue Guide

**CREATIVE
HOBART**

AN INITIATIVE OF



City of HOBART

A PLATFORM FOR
CREATIVITY



CITY
OF
HOBART

AN INCUBATOR
OF CREATIVITY

A CONNECTOR
OF CREATIVE
PEOPLE

INTRODUCTION



Hobart is attracting more attention every day for its vibrant cultural and creative products, events, festivals and people. Creative Hobart is the city's plan to be:

A "Platform" for a wide variety of diversity and cultural expression – enhancing a sense of place, activating public spaces and making the most of Council facilities.

An "Incubator" of creativity and innovation - nurturing creativity, investing in innovation and celebrating excellence and diversity.

A "Connector" of people, knowledge and information – connecting creative people, gathering and spreading knowledge, and making connections.

Hobart has a well deserved reputation as a centre for quality cultural and creative products, activities, and experiences. Hobart's cultural festivals and events draw tourists from across Tasmania, interstate and internationally.

The aim of this Guide to Creative Places is to profile some of the vast range of Council-owned venues, including everything from moody basements to ornate ballrooms and open parklands. We will continue to add venues to this guide so look out for new spaces that are ready to be filled with creative ideas, events and people.

INDEX

CITY OF HOBART	6
ALEXANDRA BATTERY	8
ARGYLE STREET CAR PARK	10
BEAUMARIS ZOO	12
BLINKING BILLY POINT	14
CASCADE GARDENS	16
CITY HALL	18
COLLINS COURT	20
CORNELIAN BAY PARK	22
ELIZABETH STREET MALL	24
FRANKLIN SQUARE	26
HOBART CENTRAL CAR PARK	28
KNOCKLOFTY	30
MATHERS HOUSE	32
MATHERS PLACE	34
MAWSON'S PLACE CAR-PARK	36
PRINCES PARK MAGAZINE	38
QUEEN VICTORIA POWDER MAGAZINE	40
RAILWAY ROUNDABOUT FOUNTAIN	42
SANDY BAY SENIOR CITIZENS CLUB	44
ST DAVIDS PARK ROTUNDA	46
TCA CRICKET GROUND	48
THE DOONE KENNEDY HOBART AQUATIC CENTRE	50
TOWN HALL	52
TOWN HALL UNDERGROUND	54
WATERWORKS RESERVE	56
WATERSIDE PAVILION	58
YOUTH ARTS & RECREATION CENTRE	60
YOUTH ARTS REHEARSAL ROOM	62
GLOSSARY	64

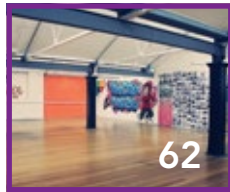
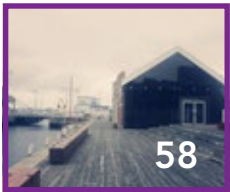
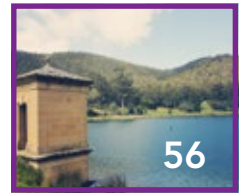
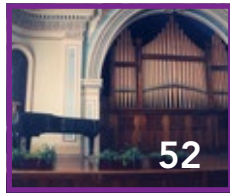
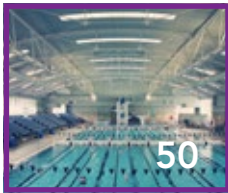
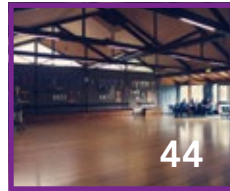
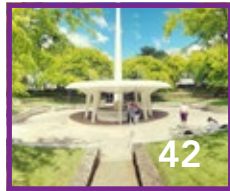
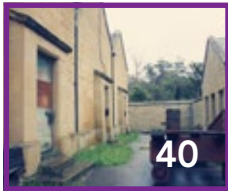
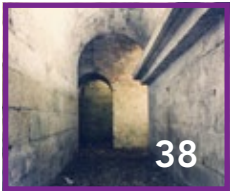
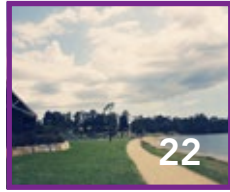



CITY OF HOBART



SKETCHING



FILM PRODUCTION



THEATRE



PAINTING



MUSIC



FESTIVALS



WRITING



PHOTOGRAPHY



SOUND INSTALLATION



INDUSTRY EVENT



LIGHT INSTALLATION



FILM PROJECTION



MARKET



HANGING EXHIBITION



DANCE



SCULPTURAL
EXHIBITION

	INDOOR	OUTDOOR	COLONIAL	NATURAL LIGHT	BLACKOUT	UNIVERSAL ACCESS	POTABLE WATER	3 PHASE POWER	RESTRICTED NOISE	CAPACITY UNSEATED	CAPACITY SEATED	TOILETS
ALEXANDRA BATTERY										1000	400	NO
ARGYLE STREET CARPARK										1000+	1000+	YES
BEAUMARIS ZOO										1000+	1000+	NO
BLINKING BILLY POINT										500	200	Yes
CASCADE GARDENS										1000+	1000+	3
CITY HALL										1240	1240	18
COLLINS COURT										~ 400	~ 150	NO
CORNELIAN BAY PARK										1000+	1000+	8
ELIZABETH STREET MALL										100+	100+	Yes
FRANKLIN SQUARE										1000+	1000+	YES
HOBART CENTRAL CARPARK										1000+	1000+	YES
KNOCKLOFTY										N/A	N/A	NO
MATHERS HOUSE										70/50	100	5
MATHERS PLACE										900	150	NO
MAWSON'S PLACE CARPARK										700 +	500 +	NO
PRINCES PARK POWDER MAGAZINE										45	15	Yes
QUEEN VICTORIA POWDER MAGAZINE										95	50	NO
RAILWAY ROUNDABOUT FOUNTAIN										~ 500	~ 500	NO
SANDY BAY CITIZENS CLUB										200	100	7
ST DAVID'S PARK ROTUNDA										85	40	3
TCA CRICKET GROUND										8000	8000	YES
THE DOONE KENNEDY HOBART AQUATIC CENTRE										TBA	850	Yes
TOWN HALL										300	300	6
TOWN HALL UNDERGROUND										120	60	NO
WATERWORKS RESERVE										1000+	1000+	9
WATERSIDE PAVILION										100	100	6
YOUTH & ARTS RECREATION CENTRE										275	115	6
YOUTH ARC REHEARSAL ROOM										100	80	7





ALEXANDRA BATTERY

CREATIVE USES

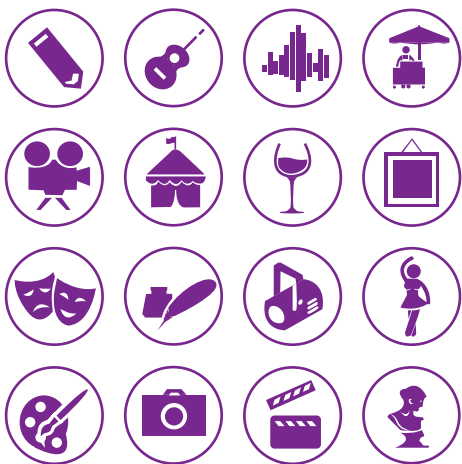

DESCRIPTION

Alexandra Battery exists as one of six batteries built in the 1880s to form the Derwent Defence Network. It is located on Sandy Bay Road, just a 12-minute drive from the city centre. Today the battery is a public park with wonderful views over the River Derwent. Much of the original structure remains making it a popular spot for film shoots, period dramas, promenade theatre, outdoor festivals and other creative events that lend themselves to the restored character of the space.

SPECIAL FEATURES

Large outdoor, historically rich space.

 **UNIVERSAL ACCESS:** Yes - limited.

M²: 1180

LOCATION

629-663 Sandy Bay Road, Sandy Bay

CONNECTIONS

CBD
Salamanca
Hobart Waterfront
Inner city accommodation

TRANSPORT



KEY INFORMATION

LARGEST OPENING	4500
CEILING HEIGHT	Open Space
FLOORING TYPE	Grass + Gravel
STREET PROMINENCE	Low

**CREATIVE
HOBART**

AN INITIATIVE OF

City of HOBART



VENUE STATS



CAPACITY	Standing approx. 1,000. Seated approx. 400
UNIVERSAL ACCESS	Yes. Some sloped grass.
TOILETS	No
EGRESS	4 x exits
BACK OF HOUSE	Off Sandy Bay Road
CATERING FACILITIES	No
HEATING	No
STORAGE	1,100mm x 6,000mm
FURNITURE	None available on site
PARKING	Unmetered street parking & carpark nearby
OUTDOOR SPACE	Yes
COST – FEES & CHARGES	Case by case basis
ABILITY TO BLACKOUT LIGHT	Some spaces
FLOOR TYPE	Grass & gravel
STAGE	No

LIGHTING	No
ACOUSTIC QUALITY	Open Space
AMBIENT NOISE ISSUES	Adjacent traffic
NOISE CONSIDERATIONS	Residential zone
POWER	No
PLACE OF ASSEMBLY LICENSE	May be required
LIQUOR LICENSE	May be required
CONTACT	Parks administration
CONTACT NUMBER	03 6238 2886
CONTACT EMAIL	parks@hobartcity.com.au
CONTACT DIVISION	Parks & City Amenity
RELEVANT LINKS	www.hobartcity.com.au/Community/Parks-reserves-and-sporting-facilities/Find-a-park-or-sportsground

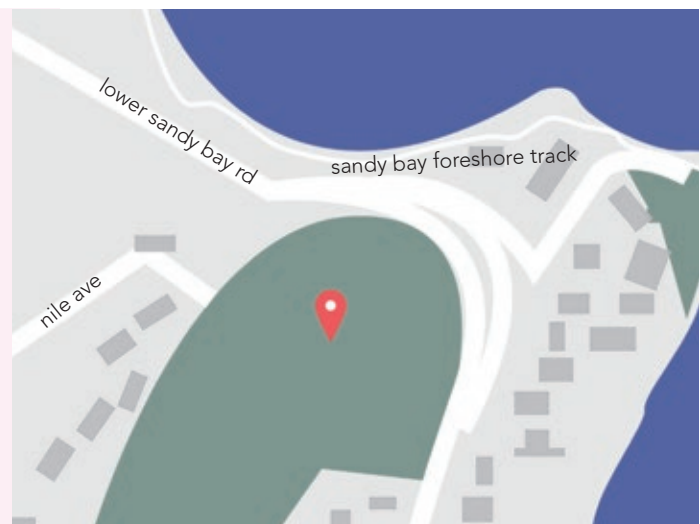
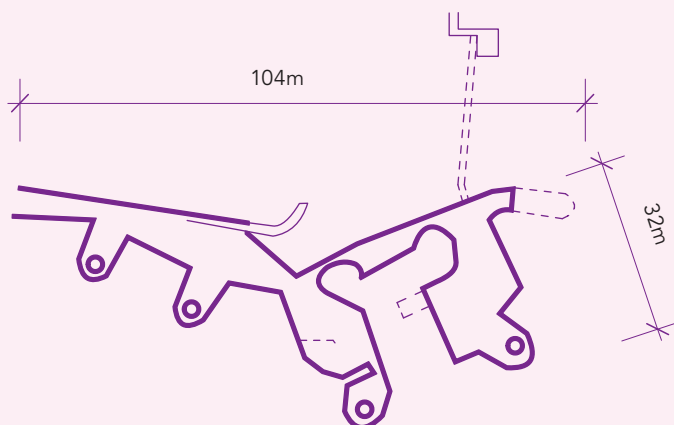



◀ ARGYLE STREET CAR PARK

CREATIVE USES



DESCRIPTION

With 1155 car spaces, Argyle Street car park is Hobart's tallest and most notable public car park. With a recent flat deck addition to support the new Wellington centre the upper-most deck is ideal for concerts, roof top cinema screenings and cinematography. This location would be ideal for musical performances, light installations, markets, roving performances, creative community projects and events.

SPECIAL FEATURES

Situated in the centre of Hobart's CBD this site provides panoramic views across Hobart to constitution dock.

 **UNIVERSAL ACCESS:** YES

M²:

LOCATION

38 Argyle st,
Hobart, Tasmania, 7000

CONNECTIONS

menzies centre
Aquatic centre
CBD
Botanical Gardens
TMAG

TRANSPORT



KEY INFORMATION

LARGEST OPENING	
CEILING HEIGHT	2000
FLOORING TYPE	Concrete
STREET PROMINENCE	High

**CREATIVE
HOBART**

AN INITIATIVE OF

City of **HOBART**



VENUE STATS



CAPACITY	1000 +
UNIVERSAL ACCESS	Yes
TOILETS	Yes (Ground floor only)
EGRESS	Ramped gradient + 3 x stair exits
BACK OF HOUSE	No
CATERING FACILITIES	No
HEATING	No
STORAGE	No
FURNITURE	No
PARKING	Metered street parking + on site
FOOD VAN ACCESSIBILITY	Yes
OUTDOOR SPACE	Yes
COST – FEES & CHARGES	Charges may apply
ABILITY TO BLACKOUT LIGHT	No
FLOOR TYPE	Concrete
STAGE	No

LIGHTING	General after-hours lighting
ACOUSTIC QUALITY	Poor - some reverb issues
AMBIENT NOISE ISSUES	Low
NOISE CONSIDERATIONS	Adjacent hospital
POWER	
PLACE OF ASSEMBLY LICENSE	May be required
LIQUOR LICENSE	May be required
CONTACT	Operations Manager - Car Parks
CONTACT NUMBER	(03) 6238 2773
CONTACT DIVISION	Parking Operations

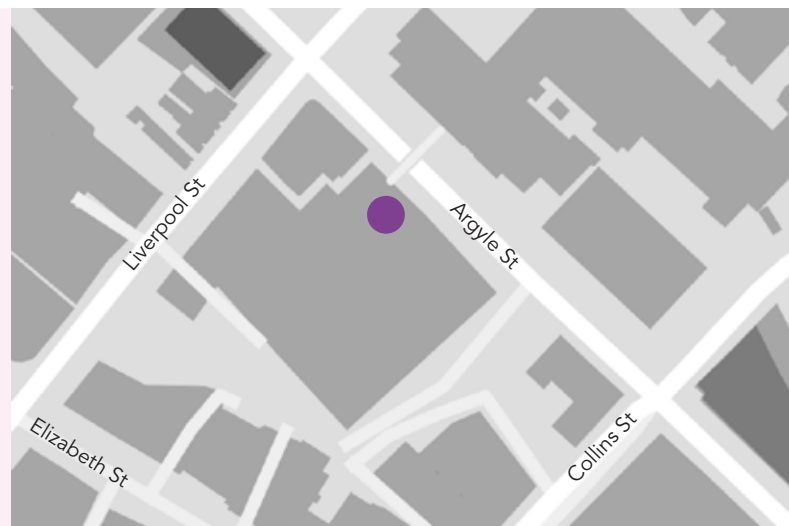
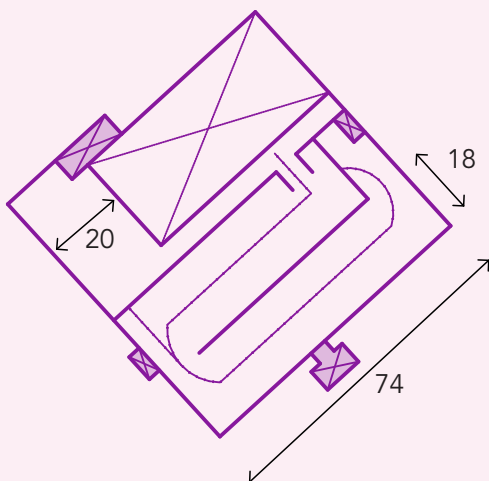



◀ BEAUMARIS ZOO

CREATIVE USES



M²: 20,000

LOCATION

Lower Domain Road, Queens Domain,
Hobart, Tasmania

CONNECTIONS

Derwent River.
Botanical Gardens
Greater Domain Area

DESCRIPTION

Situated in the Queens Domain, between Lower Domain Road and Carriage Drive is the site of the Beaumaris Zoo. Opened in 1923 on Regatta weekend, the zoo remained active for 14 years until its closure due to the Depression in 1937. The Beaumaris Zoo once housed a wide variety of animals including lions, tigers, snow leopards, elephants, monkeys and incredibly, polar bears. It is most notably remembered as the home of the last Thylacine in captivity. Today, the Beaumaris Zoo is a place of nostalgia with only the polar bear enclosure, leopard enclosure, duck pond and ticket booth remaining. The grassy, tree-lined property has a variety of European trees throughout the natural amphitheatre. Its large footprint makes it well suited to concerts, festivals, photography, community events, writing and visual art workshops.

SPECIAL FEATURES

Historically rich venue and large area.

 **UNIVERSAL ACCESS:** No

TRANSPORT



KEY INFORMATION

LARGEST OPENING	1400W x 2070H (leopard enclosure)
CEILING HEIGHT	3400 (leopard enclosure)
FLOORING TYPE	Grass + cement
STREET PROMINENCE	Low

**CREATIVE
HOBART**

AN INITIATIVE OF

City of HOBART



VENUE STATS



CAPACITY	Standing approx. 20,000
UNIVERSAL ACCESS	No
TOILETS	None
EGRESS	4 x Exits
BACK OF HOUSE	No
CATERING FACILITIES	No
HEATING	No
STORAGE	4,000mm x 2,000mm
FURNITURE	None available on site
PARKING	Metered street parking nearby
OUTDOOR SPACE	Yes
COST – FEES & CHARGES	Case by case basis
ABILITY TO BLACKOUT LIGHT	Yes (Leopard enclosure only)
FLOOR TYPE	Grass & cement
STAGE	No

LIGHTING	None
ACOUSTIC QUALITY	Outdoor, open space
AMBIENT NOISE ISSUES	Adjacent traffic
NOISE CONSIDERATIONS	Nearby residents
POWER	Yes, limited
PLACE OF ASSEMBLY LICENSE	May be required
LIQUOR LICENSE	May be required
CONTACT	Parks administration
CONTACT NUMBER	03 6238 2886
CONTACT EMAIL	parks@hobartcity.com.au
CONTACT DIVISION	Parks & City Amenity

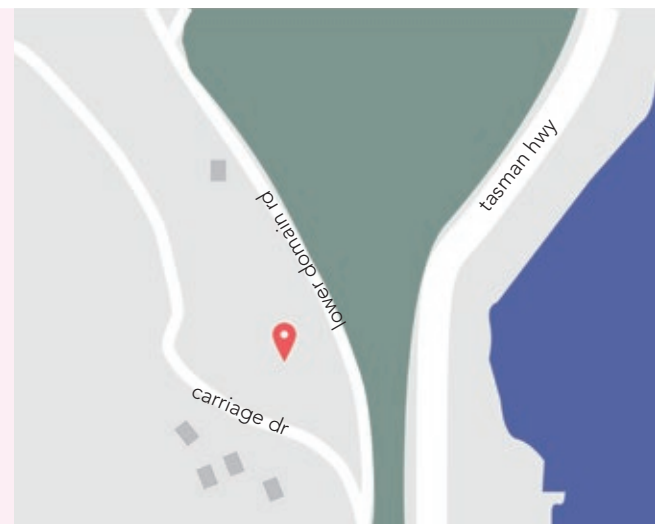
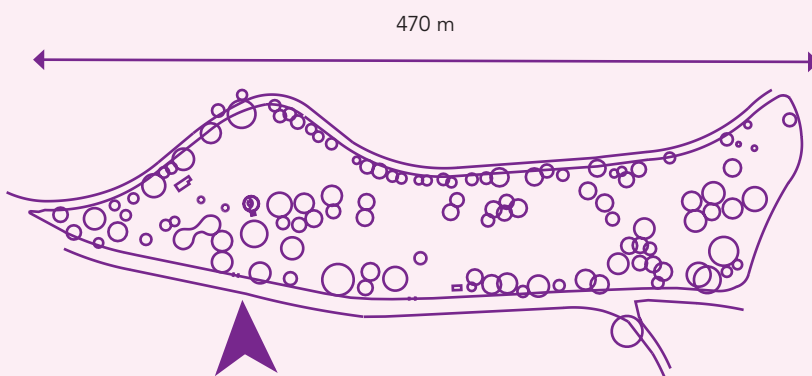



◀ BLINKING BILLY POINT

CREATIVE USES



DESCRIPTION

Named affectionately after harbour master William Watchorn, Blinking Billy Point once housed two spotlights on its embankment. From 1890 until the Second World War, these spotlights worked in conjunction with a series of batteries that formed Hobart's Derwent Defence Network, in particular Alexandra Battery and after 1909 Fort Nelson. Tucked away below a navigational beacon, the remains of the spotlight encasements offer excellent views of the River Derwent. A well-maintained path from Long Beach leads to below these remains, placing them in perfect position for theatre and musical performances, film shoots, photography, promenade theatre, projection and light installations.

SPECIAL FEATURES

Attractive waterfront promenade leading to large flat open space.

 **UNIVERSAL ACCESS:** Partial

M²: 540

LOCATION

Lower Sandy Bay Road, Sandy Bay, Hobart.

CONNECTIONS

CBD
Salamanca
Hobart Waterfront
Inner city accommodation

TRANSPORT



KEY INFORMATION

LARGEST OPENING	1500W x 2000H (ruins)
CEILING HEIGHT	2200 (ruins)
FLOORING TYPE	Cement, grass, asphalt.
STREET PROMINENCE	Low

**CREATIVE
HOBART**

AN INITIATIVE OF

City of **HOBART**



VENUE STATS



CAPACITY	Standing 500, Seated 200
UNIVERSAL ACCESS	Yes to Point, No to Ruins
TOILETS	Within 300m
EGRESS	2 x exits via foreshore track
BACK OF HOUSE	Off Sandy Bay Road
CATERING FACILITIES	No
HEATING	No
STORAGE	No
FURNITURE	None available on site
PARKING	2 carparks & on-street available
OUTDOOR SPACE	Yes. Shared public space.
COST – FEES & CHARGES	Case by case basis
ABILITY TO BLACKOUT LIGHT	No
FLOOR TYPE	Cement, grass, asphalt
STAGE	No

LIGHTING	None
ACOUSTIC QUALITY	Open space
AMBIENT NOISE ISSUES	Water activity, pumphouse, residents
NOISE CONSIDERATIONS	Residential area
POWER	None
PLACE OF ASSEMBLY LICENSE	May be required
LIQUOR LICENSE	May be required
CONTACT	Parks administration
CONTACT NUMBER	03 6238 2886
CONTACT EMAIL	parks@hobartcity.com.au
CONTACT DIVISION	Park & City Amenity
RELEVANT LINKS	www.hobartcity.com.au/Community/Parks-reserves-and-sporting-facilities/Find-a-park-or-sportsground

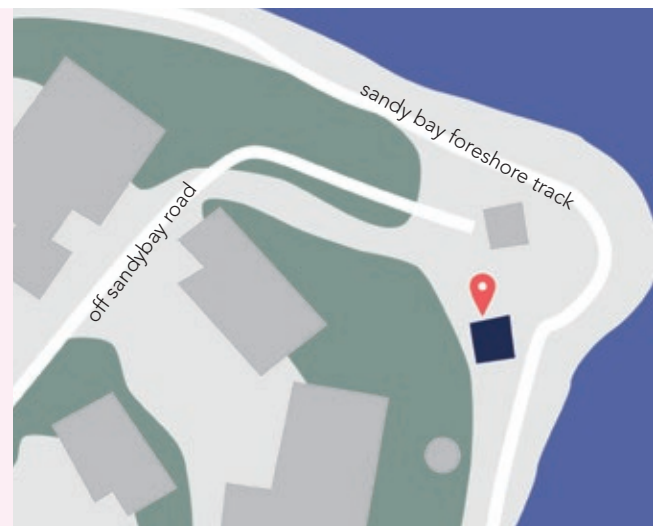
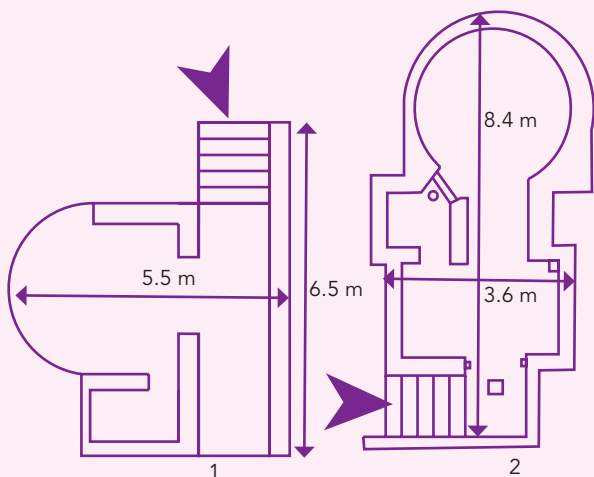



◀ CASCADE GARDENS

CREATIVE USES

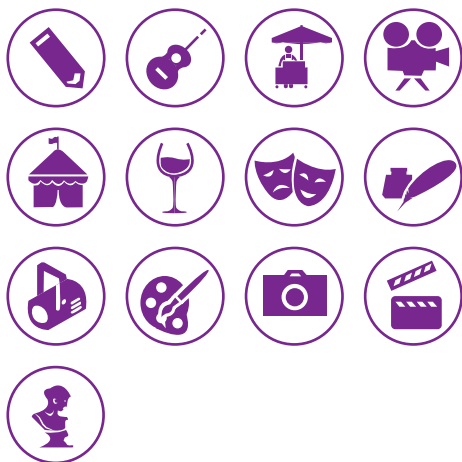

DESCRIPTION

Situated in the foothills of Mt. Wellington, the Cascade Gardens provide a lush, tree shaded area close to the heart of the city. The venue has a rich history dating back to the establishment of the Female Factory in 1827, when the gardens were planted to halt development around the site. The Cascade Gardens are also closely connected to the Hobart Rivulet, a creek running through the site. An easily accessed area, this venue would provide a perfect backdrop for light installations, promenade theatre, poetry readings, creative community projects.

SPECIAL FEATURES

Spectacular views to the Cascade Brewery and nestled beneath Mt. Wellington

 **UNIVERSAL ACCESS:** Yes

LOCATION

McRobies Road
South Hobart, Tasmania 7000

CONNECTIONS

Mt Wellington
Cascade Brewery
Linear Park

TRANSPORT



KEY INFORMATION

LARGEST OPENING	N/A
CEILING HEIGHT	Open Space
FLOORING TYPE	Grass, landscaping, paths defined.
STREET PROMINENCE	Low

**CREATIVE
HOBART**

AN INITIATIVE OF

City of **HOBART**



VENUE STATS



CAPACITY	Open Space
UNIVERSAL ACCESS	Yes
TOILETS	1 x F, 1 x M, 1 x UAXS
EGRESS	2 x Exits + stairs to cascade road
BACK OF HOUSE	via McRobies Road
CATERING FACILITIES	BBQ facilities x 2
HEATING	No
STORAGE	No
FURNITURE	None available on site
PARKING	15 + unmetered street parking
OUTDOOR SPACE	Yes
COST – FEES & CHARGES	Case by case basis
ABILITY TO BLACKOUT LIGHT	No
FLOOR TYPE	Grass, landscaping, paths defined
STAGE	No

LIGHTING	Paths and amenities lit
ACOUSTIC QUALITY	Outdoor, open space
AMBIENT NOISE ISSUES	Adjacent traffic + Hobart Rivulet
NOISE CONSIDERATIONS	Residential area
POWER	GPO power in bollard near top brewery barbeques & boulder trap
PLACE OF ASSEMBLY LICENSE	May be required
LIQUOR LICENSE	May be required
CONTACT	Parks administration
CONTACT NUMBER	03 6238 2886
CONTACT EMAIL	parks@hobartcity.com.au
CONTACT DIVISION	Park & City Amenity
RELEVANT LINKS	www.hobartcity.com.au/Community/Parks-reserves-and-sporting-facilities/Find-a-park-or-sportsground

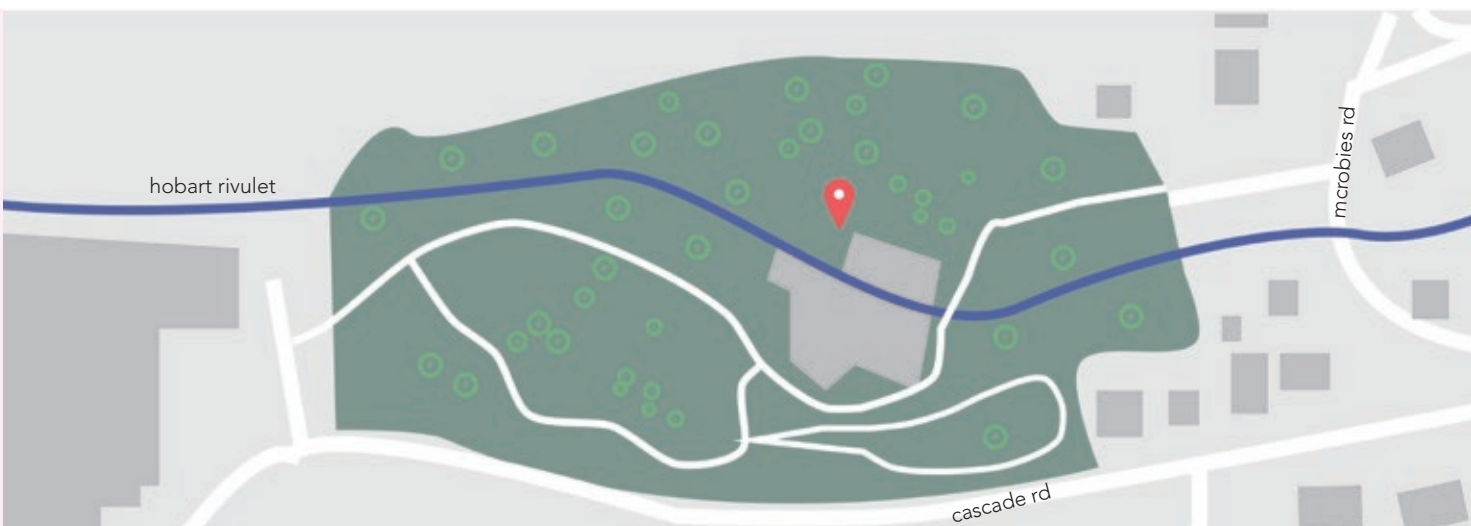



CITY HALL

CREATIVE USES



M²: 2000

LOCATION

57-63 Maquarie Street Hobart,
Tasmania 7000

CONNECTIONS

CBD
Salamanca
Hobart Waterfront
Inner city accommodation.
Tasmanian Museum & Art Gallery

DESCRIPTION

Originally the site of the Council Market, construction began on City Hall in 1914, the time of World War I. Despite the conflict, the building was completed by 1915. Its ample, majestic interior remains in the original condition, featuring tiered mezzanine seating, hardwood floors and an impressive pressed-tin roof. Over the years this venue has hosted many events from theatre, boxing and wrestling, markets, debating, award ceremonies, fairs and school dances; each using a different configuration to suits the diverse activities. This site could be ideal for makers markets, large scale live performance, sizeable exhibitions and group workshops.

SPECIAL FEATURES

Ornate pressed tin, curvilinear ceiling.

 **UNIVERSAL ACCESS:** Yes

TRANSPORT



KEY INFORMATION

LARGEST OPENING	3600W x 2700H
CEILING HEIGHT	12000
FLOORING TYPE	Timber
STREET PROMINENCE	High

**CREATIVE
HOBART**

AN INITIATIVE OF

City of **HOBART**



VENUE STATS



CAPACITY	Standing 1,240. Seated 1,240
UNIVERSAL ACCESS	Yes, to lower floors
TOILETS	F x 11, M x 4, UAXS x 3
EGRESS	8 x Exits
BACK OF HOUSE	Unload via Market Place
CATERING FACILITIES	Kitchenette
HEATING	Yes (at additional cost)
STORAGE	4,000 x 5,000 by 2
FURNITURE	600 stackable seats available
PARKING	Metered street parking
OUTDOOR SPACE	None
COST – FEES & CHARGES	Commercial \$306/hr, \$4,080/wk Non commercial \$155/hr, 2,040/wk
ABILITY TO BLACKOUT LIGHT	No
FLOOR TYPE	Timber
STAGE	10,900 x 9,700

LIGHTING	Industrial fluorescent and stage lighting
ACOUSTIC QUALITY	High reverb. Basic public address available
AMBIENT NOISE ISSUES	Adjacent traffic
NOISE CONSIDERATIONS	Youth Arc
POWER	Standard and 3 phase
PLACE OF ASSEMBLY LICENSE	May be required
LIQUOR LICENSE	May be required
CONTACT NAME	Hallkeeping
CONTACT NUMBER	03 6238 2765
CONTACT EMAIL	hallbookingenquiries@hobartcity.com.au
CONTACT DIVISION	Corporate Services
RELEVANT LINKS	www.hobartcity.com.au/City-services/Venues-banners-and-signage/Halls-and-venues/City-Hall

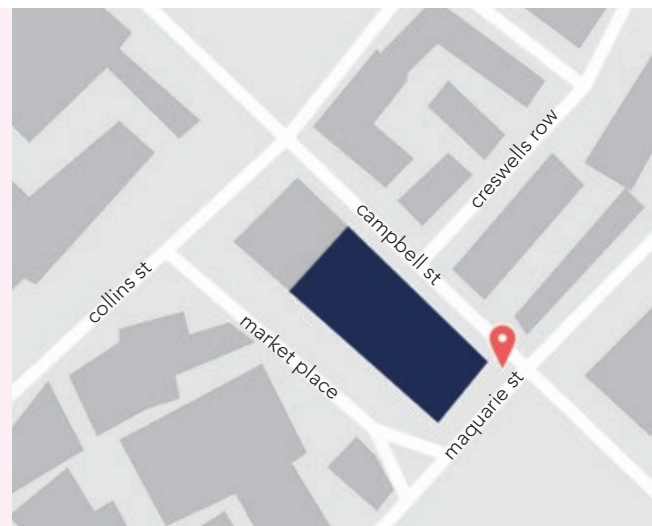
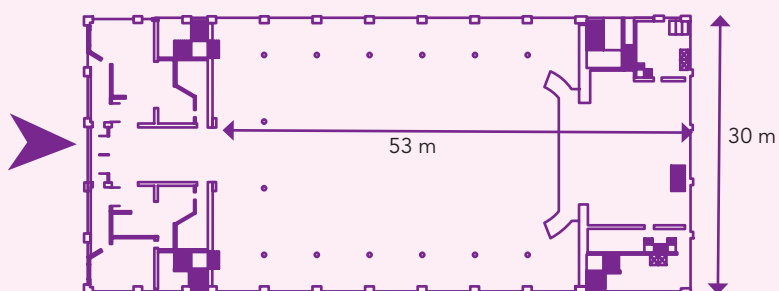



◀ COLLINS COURT

CREATIVE USES



M²: ~590

DESCRIPTION

Redeveloped in 2016 by local design studio Playstreet, Collins Court has been transformed into a serene inner city retreat which is utilized by city workers as a time out space. The space has been designed to accommodate families, performance, social gatherings, after-work gatherings and food trucks. This site provides the perfect location for creative community events, poetry readings, light installations, projections, performative arts, musical events, craft markets, installations and night markets.

SPECIAL FEATURES

High street prominence green-space refuge.

 UNIVERSAL ACCESS: YES

LOCATION

134 Collins Crt,
Hobart, Tasmania, 7000

CONNECTIONS

CBD
Salamanca
Cat + fiddle Arcade

TRANSPORT



KEY INFORMATION

LARGEST OPENING	N/A
CEILING HEIGHT	N/A
FLOORING TYPE	Concrete + Paved
STREET PROMINENCE	High

**CREATIVE
HOBART**

AN INITIATIVE OF

City of HOBART



VENUE STATS



CAPACITY	~400
UNIVERSAL ACCESS	Yes
TOILETS	No
EGRESS	1 main exit, 2 secondary exits
BACK OF HOUSE	No
CATERING FACILITIES	No
HEATING	No
STORAGE	No
FURNITURE	Perm. Seating for ~50pax
PARKING	Meter & HCC car park
FOOD VAN ACCESSIBILITY	Yes, via back entry only
OUTDOOR SPACE	Yes
COST – FEES & CHARGES	Case by case basis
ABILITY TO BLACKOUT LIGHT	No
FLOOR TYPE	Concrete & Paved
STAGE	4.5m x 3.8m (AV. Equip)

LIGHTING	Yes
ACOUSTIC QUALITY	Reverb. issue form surrounding building
AMBIENT NOISE ISSUES	Street Noise
NOISE CONSIDERATIONS	No
POWER	Yes
PLACE OF ASSEMBLY LICENSE	May be required
LIQUOR LICENSE	May be required
CONTACT	Marketing Coordinator
CONTACT NUMBER	03 6238 2890
CONTACT EMAIL	marketing@hobartcity.com.au
CONTACT DIVISION	Communications & Marketing

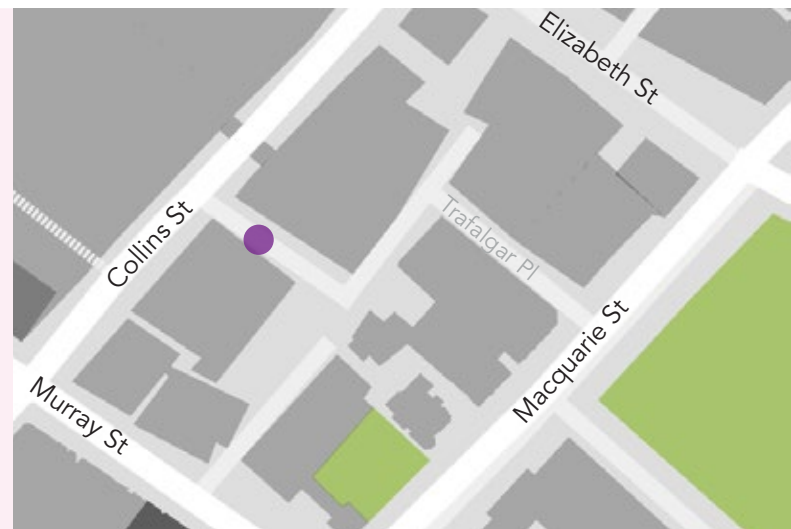
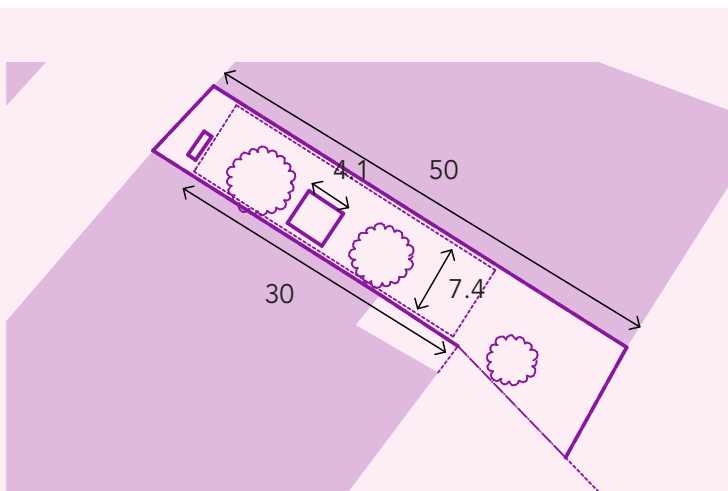



◀ CORNELIAN BAY PARK

CREATIVE USES



DESCRIPTION

Historically a government farm which provided produce and grazing land for the growing colony, Cornelian Bay is now a picturesque embayment to the north of the City of Hobart. It provides a popular and unique coastal experience close to the heart of the city. Facilities include sheltered barbeque areas, toilets, play equipment and ample lawn area. The park overlooks the Tasman Bridge, historic boatsheds and the bay, which is used for sailing and water recreation. Cornelian Bay provides the perfect space for film shoots, creative community events, poetry readings, light installations, musical events and craft markets.

SPECIAL FEATURES

Excellent views across the Derwent River and to the nearby boatsheds.

 **UNIVERSAL ACCESS:** Yes

LOCATION

Queens Walk, New Town, Hobart, Tasmania 7008

CONNECTIONS

Greater Domain Area
Intercity cycleway
Visual link to Eastern Shore

TRANSPORT



KEY INFORMATION

LARGEST OPENING	N/A
CEILING HEIGHT	Open space
FLOORING TYPE	Grass, paths defined.
STREET PROMINENCE	Low

**CREATIVE
HOBART**

AN INITIATIVE OF

City of **HOBART**



VENUE STATS



CAPACITY	Open Space
UNIVERSAL ACCESS	Yes
TOILETS	3 x F, 3 x M, 2 x babychange, 2 x UAXS
EGRESS	3 x Exits to Queens Parade
BACK OF HOUSE	Access via carparks
CATERING FACILITIES	BBQ
HEATING	No
STORAGE	No
FURNITURE	None available on site
PARKING	90+ and unmetered street parking
OUTDOOR SPACE	Yes. Sports groups nearby.
COST – FEES & CHARGES	Case by case basis
ABILITY TO BLACKOUT LIGHT	No
FLOOR TYPE	grass, paths defined

STAGE	No
LIGHTING	Street lighting
ACOUSTIC QUALITY	Outdoor, Open space
AMBIENT NOISE ISSUES	Adjacent water activity, adjacent traffic
NOISE CONSIDERATIONS	None. Sports Ground & Restaurant.
POWER	None
PLACE OF ASSEMBLY LICENSE	May be required
LIQUOR LICENSE	May be required
CONTACT	Parks administration
CONTACT NUMBER	03 6238 2886
CONTACT EMAIL	parks@hobartcity.com.au
CONTACT DIVISION	Park & City Amenity
RELEVANT LINKS	www.hobartcity.com.au/Community/Parks-reserves-and-sporting-facilities/Find-a-park-or-sportsground

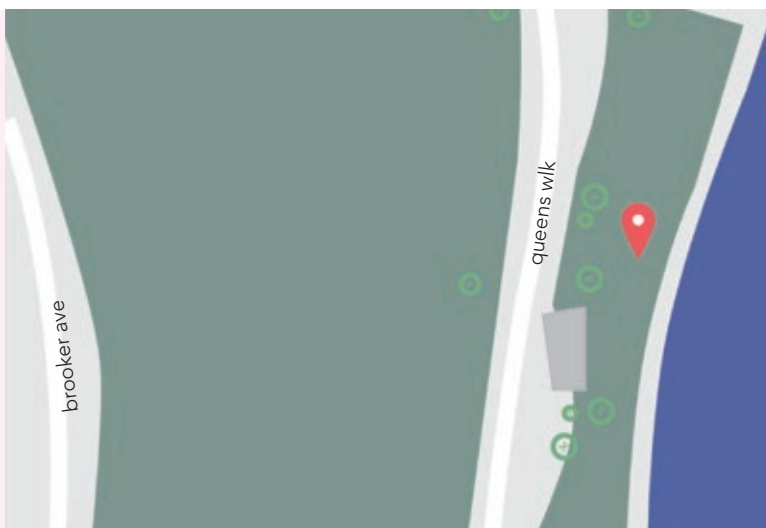



ELIZABETH STREET MALL

CREATIVE USES



DESCRIPTION

Located within the city centre, the tree-lined Elizabeth Street Mall presents opportunities for sheltered outdoor entertainment and events that capture the eye of the Hobart public. Closed off in the 1970s and redeveloped in the late 90s, Elizabeth Street Mall is well known as a popular congregation and performance area within the city.

It has 64m² of sheltered, level paved outdoor space with universal access. With lighting for evening events and a short distance to amenities, the mall could be the perfect venue for small-scale music and other performance, exhibitions and community events.

SPECIAL FEATURES

Highly prominent foot traffic and sheltered outdoor space.

 **UNIVERSAL ACCESS:** Yes

M²: 48

LOCATION

Elizabeth Street between Collins and Liverpool Street

CONNECTIONS

Key link within CBD.
Liverpool St & Collins St.
Cat + Fiddle Arcade

TRANSPORT



KEY INFORMATION

LARGEST OPENING	N/A
CEILING HEIGHT	N/A
FLOORING TYPE	Level pavement.
STREET PROMINENCE	High

**CREATIVE
HOBART**

AN INITIATIVE OF

City of HOBART



VENUE STATS



CAPACITY	25, or more by request
UNIVERSAL ACCESS	Yes
TOILETS	Wellington Centre and Argyle Street Carpark
EGRESS	Open space to Collins and Liverpool Street
BACK OF HOUSE	Access via Liverpool Street
CATERING FACILITIES	Restrictions apply to catering
HEATING	No
STORAGE	No
FURNITURE	Street furniture
PARKING	Metered street parking and multi storey
OUTDOOR SPACE	Yes. Limited space available.
COST – FEES & CHARGES	No hire fee
ABILITY TO BLACKOUT LIGHT	No
FLOOR TYPE	Level pavement

STAGE	No
LIGHTING	Street lighting
ACOUSTIC QUALITY	High reverb
AMBIENT NOISE ISSUES	CBD
NOISE CONSIDERATIONS	Adjacent businesses
POWER	Standard power, limited access.
PLACE OF ASSEMBLY LICENSE	May be required
LIQUOR LICENSE	Restrictions apply to provision of drinks
CONTACT NAME	Marketing Coordinator
CONTACT NUMBER	03 6238 2890
CONTACT EMAIL	marketing@hobartcity.com.au
CONTACT DIVISION	Communications & Marketing
RELEVANT LINKS	www.hobartcity.com.au/City-services/Venues-banners-and-signage/Elizabeth-Mall-Salamanca-Square-and-Speakers-Corner

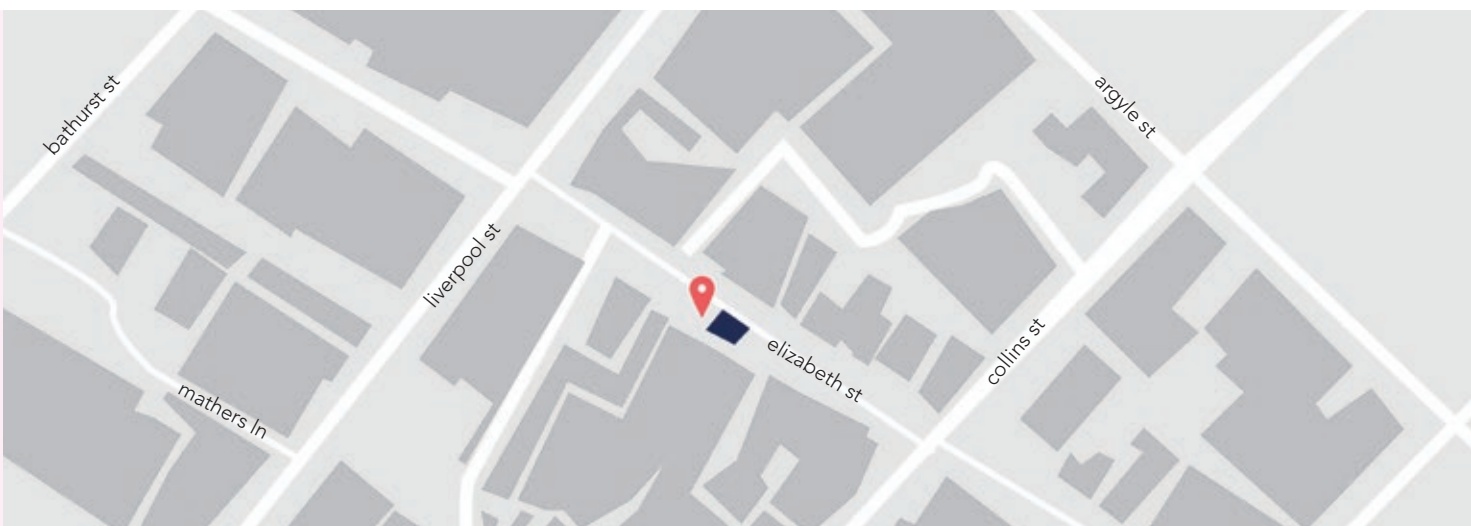



◀ FRANKLIN SQUARE

CREATIVE USES

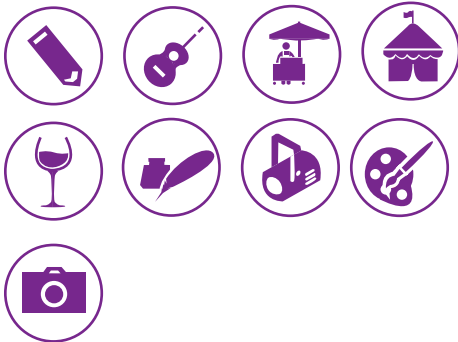

DESCRIPTION

Located between Sullivan’s Cove and Hobart’s CBD Franklin Square is Hobart’s most prominent and central recreational park of Hobart.

Named after the former Governor of Van Diemen’s Land – John Franklin this Heritage listed Victorian style park occupies the site allocated for old government house. Lined with Oak trees that bound Hobart’s largest fountain, the space is a much loved green space refuge for locals and visitors alike. The recent refurbishments enable Franklin Square to be envisioned for multiple creative platforms and has been showcased for events including lighting installations projected on trees for Mona Foma and the Friday night Street Eats @ Franko, which includes 23 stalls installations and food vans, live music, films and performative arts.

SPECIAL FEATURES

Historically rich green space situated in the CBD.

 **UNIVERSAL ACCESS:** YES

M²: 6323

LOCATION

70 Macquarie Street,
Hobart, Tasmania, 7000

CONNECTIONS

CBD
Salamanca
Parliament House
City Hall
TMAG

TRANSPORT



KEY INFORMATION

LARGEST OPENING	N/A
CEILING HEIGHT	N/A
FLOORING TYPE	Concrete
STREET PROMINENCE	High

**CREATIVE
HOBART**

AN INITIATIVE OF

City of **HOBART**



VENUE STATS



CAPACITY	1000+
UNIVERSAL ACCESS	Yes
TOILETS	Yes
EGRESS	6 x exits
BACK OF HOUSE	No
CATERING FACILITIES	No
HEATING	No
STORAGE	No
FURNITURE	Perm. Seating for ~100
PARKING	Metered & multistory Car park
FOOD VAN ACCESSIBILITY	Yes via Government house car park
OUTDOOR SPACE	Yes
COST – FEES & CHARGES	Some charges may apply
ABILITY TO BLACKOUT LIGHT	No
FLOOR TYPE	Paved, Concrete + Grass
STAGE	No

LIGHTING	Yes
ACOUSTIC QUALITY	Poor
AMBIENT NOISE ISSUES	High street traffic
NOISE CONSIDERATIONS	No
POWER	Yes
PLACE OF ASSEMBLY LICENSE	May be required
LIQUOR LICENSE	May be required
CONTACT	Parks administration
CONTACT NUMBER	(03) 6238 2886
CONTACT EMAIL	parks@hobartcity.com.au
CONTACT DIVISION	Parks & City Amenity Division
RELEVANT LINKS	www.hobartcity.com.au/Community/Parks-reserves-and-sporting-facilities/Find-a-park-or-sportsground

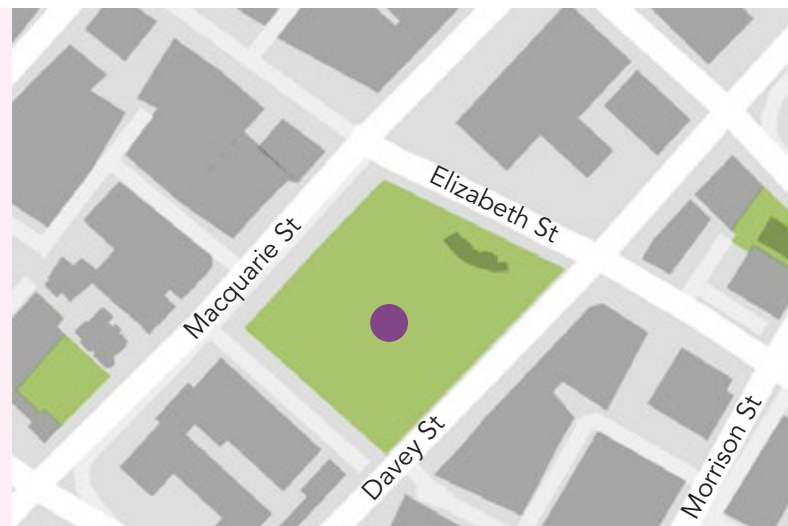
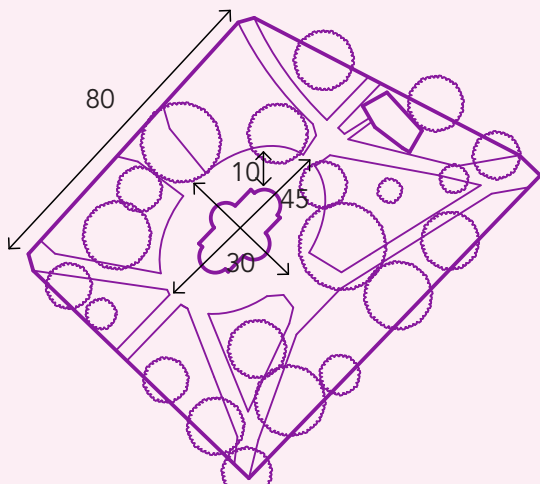



◀ HOBART CENTRAL CAR PARK

CREATIVE USES



DESCRIPTION

Recently hosting the day of the dead festival, the Hobart central car park provides the ideal open air, inner city location for festivals, performance and cinema. Hidden from the street but enjoying spectacular views of the city, the roof top provides an unexpected location for events. This location would be ideal for musical performances, light installations, markets, roving performances, creative community projects and events.

SPECIAL FEATURES

Situated in the centre of Hobart's CBD this site provides panoramic views across Hobart.

 UNIVERSAL ACCESS: NO

M²:

LOCATION

Melville St,
Hobart, Tasmania, 7000

CONNECTIONS

menzies centre
Aquatic centre
CBD
Botanical Gardens
TMAG

TRANSPORT



KEY INFORMATION

LARGEST OPENING	
CEILING HEIGHT	2300
FLOORING TYPE	Concrete
STREET PROMINENCE	High

**CREATIVE
HOBART**

AN INITIATIVE OF

City of **HOBART**



VENUE STATS



CAPACITY	1000 +
UNIVERSAL ACCESS	Yes
TOILETS	Yes (ground floor only)
EGRESS	Lifts and 3 x stair exits
BACK OF HOUSE	No
CATERING FACILITIES	No
HEATING	No
STORAGE	No
FURNITURE	No
PARKING	Metered street parking + on site
FOOD VAN ACCESSIBILITY	Yes
OUTDOOR SPACE	Yes
COST – FEES & CHARGES	Charges may apply
ABILITY TO BLACKOUT LIGHT	No
FLOOR TYPE	Concrete

STAGE	No
LIGHTING	General lighting
ACOUSTIC QUALITY	Poor - some reverb
AMBIENT NOISE ISSUES	Low
NOISE CONSIDERATIONS	No
POWER	
PLACE OF ASSEMBLY LICENSE	May be required
LIQUOR LICENSE	May be required
CONTACT	Operations Manager - Car Parks
CONTACT NUMBER	(03) 6238 2773
CONTACT DIVISION	Parking Operations

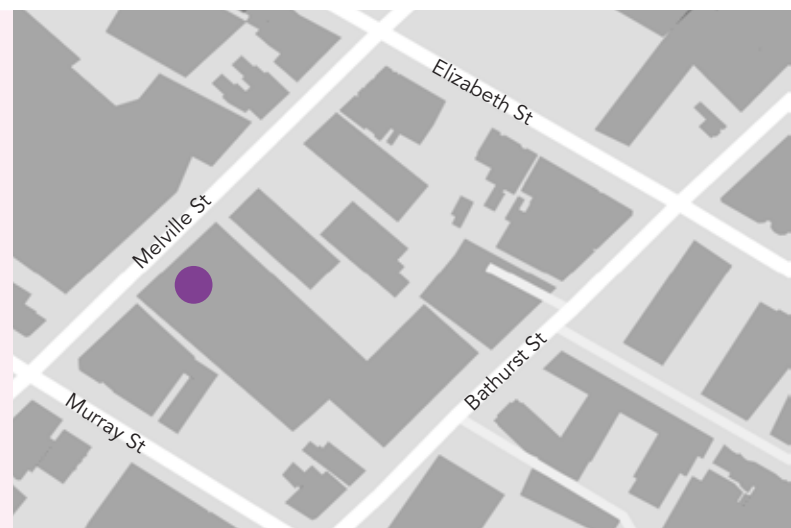
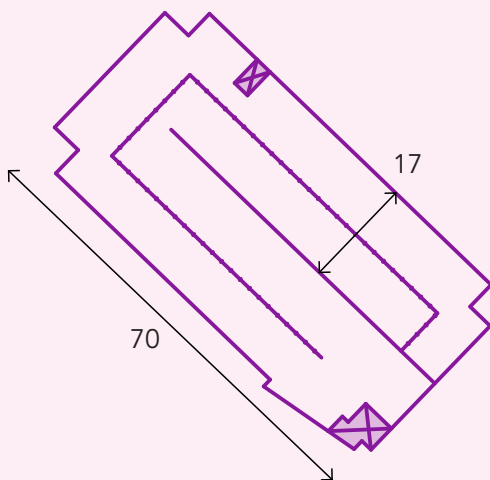



◀ KNOCKLOFTY

CREATIVE USES



DESCRIPTION

Covering 140 hectares of bushland Knocklofty Reserve links Hobart to Wellington Reserve and delivers spectacular views of Hobart CBD, South Hobart, Tollmans Hill, Sandy Bay, Derwent River and Eastern Shore. The Tasmanian Aboriginal Mouheneener people originally called this region the Nibberloone or Linghe areas and used the rich resources of the land to provide food, medicine and shelter.

Early settlers used the area for firewood, quarrying of sandstone, brick making and grazing. A popular destination for artists, the site was featured in many early paintings including a prominent John Glover painting featuring early hunting on the site. The City of Hobart purchased the woodlands in 1942, they are now enjoyed by local walking groups, families, dogs and their owners. The reserve includes numerous picnic spots and lookout points on the Hobart side of the 375m summit. This site would provide the perfect location for light installations, poetry readings and creative community projects.

SPECIAL FEATURES

Large bushlands rich in Tasmanian history and fauna & flora.

M²: OPEN SPACE BUSHLAND

UNIVERSAL ACCESS: NO

LOCATION

Knocklofty Reserve,
West Hobart, Tasmania, 7000

TRANSPORT



CONNECTIONS

Bicentennial park
Waterworks Reserve
CBD

KEY INFORMATION

LARGEST OPENING	N/A
CEILING HEIGHT	N/A
FLOORING TYPE	Gravel
STREET PROMINENCE	Low

**CREATIVE
HOBART**

AN INITIATIVE OF
 City of **HOBART**



VENUE STATS



CAPACITY	Open air
UNIVERSAL ACCESS	No
TOILETS	No
EGRESS	6 walking exits
BACK OF HOUSE	No
CATERING FACILITIES	No
HEATING	No
STORAGE	No
FURNITURE	Some picnic tables
PARKING	Limited car parking
FOOD VAN ACCESSIBILITY	Car park only
OUTDOOR SPACE	Yes
COST – FEES & CHARGES	Some charges may apply
ABILITY TO BLACKOUT LIGHT	No
FLOOR TYPE	Fire trails and walking tracks
STAGE	No

LIGHTING	No
ACOUSTIC QUALITY	Open air
AMBIENT NOISE ISSUES	No
NOISE CONSIDERATIONS	Close proximity to residential areas
POWER	No
PLACE OF ASSEMBLY LICENSE	May be required
LIQUOR LICENSE	May be required
CONTACT	Parks administration
CONTACT NUMBER	(03) 6238 2886
CONTACT EMAIL	parks@hobartcity.com.au
CONTACT DIVISION	Parks & city Amenity Division
RELEVANT LINKS	www.hobartcity.com.au/Community/Parks-reserves-and-sporting-facilities/Find-a-park-or-sportsground





◀ MATHERS HOUSE

CREATIVE USES



DESCRIPTION

Mathers House, originally the Archibald Park Memorial Building was built in 1959 as a "60 and Over's" club. Built by the Council, today Mathers House still has a focus on senior members of the community, but is a vibrant space open to everyone. The upper floor is a large, bright, open space with kitchen facilities, making it good for workshops, artist talks and small recitals. The lower level is a medium-size room with full length mirrors making it perfect for dance rehearsals and performances, films and master classes. The room can also be fully blacked out.

SPECIAL FEATURES

Central city location, with spill out onto Mathers Place.

 **UNIVERSAL ACCESS:** Yes

M²: 120^(GRND), 80^(LWR)

LOCATION

108 Bathurst Street, Hobart, Tasmania 7000

CONNECTIONS

CBD
Salamanca
Hobart Waterfront
Inner city accommodation

TRANSPORT



KEY INFORMATION

LARGEST OPENING 840W x 2010H ^(1st) + 1010W x 2020H ^(2nd)
CEILING HEIGHT 2600 ^(1st) + 3450 ^(2nd)
FLOORING TYPE Lino, Tiles, Carpet.
STREET PROMINENCE Prominent within Mathers Lane.

**CREATIVE
HOBART**

AN INITIATIVE OF

 City of **HOBART**



VENUE STATS



CAPACITY	Main Hall – 70 Seated; Multipurpose Room – 50 Seated. Max. 100 capacity
UNIVERSAL ACCESS	Yes
TOILETS	2 x F, 2 x M, 2 x UAXS. Babychange.
EGRESS	2 Exits
BACK OF HOUSE	Off Bathurst Street
CATERING FACILITIES	Commercial kitchen facilities
HEATING	Heat pumps
STORAGE	3,000 x 3,000
FURNITURE	Tables and chairs
PARKING	Metered street parking, multi storey carpark near by
OUTDOOR SPACE	Yes
COST – FEES & CHARGES	Varies depending upon space required, deposit required.
ABILITY TO BLACKOUT LIGHT	No

FLOOR TYPE	Lino, tiles and carpet
STAGE	No
LIGHTING	Fluorescent tube
ACOUSTIC QUALITY	Low reverb
AMBIENT NOISE ISSUES	Adjacent traffic
NOISE CONSIDERATIONS	CBD, Childcare centre, library
POWER	Standard outlets
PLACE OF ASSEMBLY LICENSE	Current License in place
LIQUOR LICENSE	May be required
CONTACT NAME	Mathers House Coordinator
CONTACT NUMBER	03 6234 1441
CONTACT EMAIL	mathersplace@hobartcity.com.au
CONTACT DIVISION	Community Development
RELEVANT LINKS	www.hobartcity.com.au/ Community/Venues-banners-and- signage/Halls-and-venues

MAIN HALL (GRND)

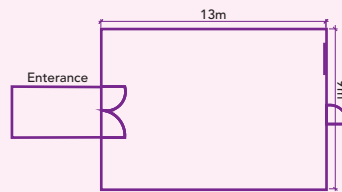

MULTIPURPOSE ROOM (LWR)

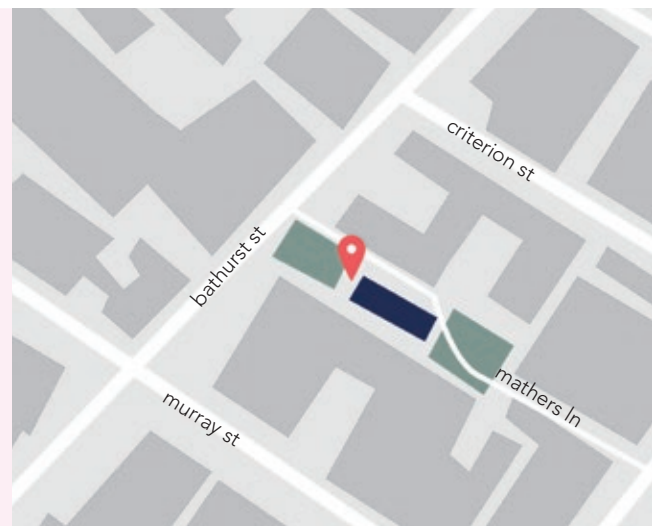
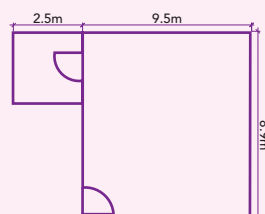



◀ MATHERS PLACE

CREATIVE USES



DESCRIPTION

A pedestrian link between Bathurst, Liverpool and Criterion Streets, Mathers Lane is a popular thoroughfare within the city centre. The sloping lane leads to Mathers Place, which contains a manicured, level grassed areas and amphitheatre-style seating to pause and take in the inner city atmosphere. Mathers Place provides the perfect venue for cabaret, theatre and street performances. Because it sits alongside Hobart’s Playhouse Theatre it could provide an outdoor function space for opening nights or roving performances.

SPECIAL FEATURES

Quiet, inner city green space.

 **UNIVERSAL ACCESS:** Yes, steep walkway.

M²: 900

LOCATION

108 Bathurst Street, Hobart, Tasmania 7000

CONNECTIONS

CBD
Salamanca
Hobart Waterfront
Inner city accommodation

TRANSPORT



KEY INFORMATION

LARGEST OPENING	N/A
CEILING HEIGHT	Open Space
FLOORING TYPE	Paved, grass, artificial grass.
STREET PROMINENCE	Low

**CREATIVE
HOBART**

AN INITIATIVE OF

City of **HOBART**



VENUE STATS



CAPACITY	Standing – 900, Seated – 150
UNIVERSAL ACCESS	Yes, steep walkway
TOILETS	None
EGRESS	Bathurst, Liverpool & Criterion Sts.
BACK OF HOUSE	Off Bathurst Street
CATERING FACILITIES	no
HEATING	No
STORAGE	Potential to use Mathers House
FURNITURE	Street furniture
PARKING	Metered street parking, multi storey nearby
OUTDOOR SPACE	Yes
COST – FEES & CHARGES	Case by case basis
ABILITY TO BLACKOUT LIGHT	No
FLOOR TYPE	Paved, grass, artificial grass
STAGE	No

LIGHTING	Street lighting, surrounding buildings uplit
ACOUSTIC QUALITY	High reverb
AMBIENT NOISE ISSUES	Adjacent traffic
NOISE CONSIDERATIONS	CBD, Childcare centre, Library
POWER	Standard Power
PLACE OF ASSEMBLY LICENSE	May be required
LIQUOR LICENSE	May be required
CONTACT NAME	Mathers House Coordinator
CONTACT NUMBER	03 6234 1441
CONTACT EMAIL	matherspace@hobartcity.com.au
CONTACT DIVISION	Community Development
RELEVANT LINKS	www.hobartcity.com.au/Community/Venues-banners-and-signage/Halls-and-venues

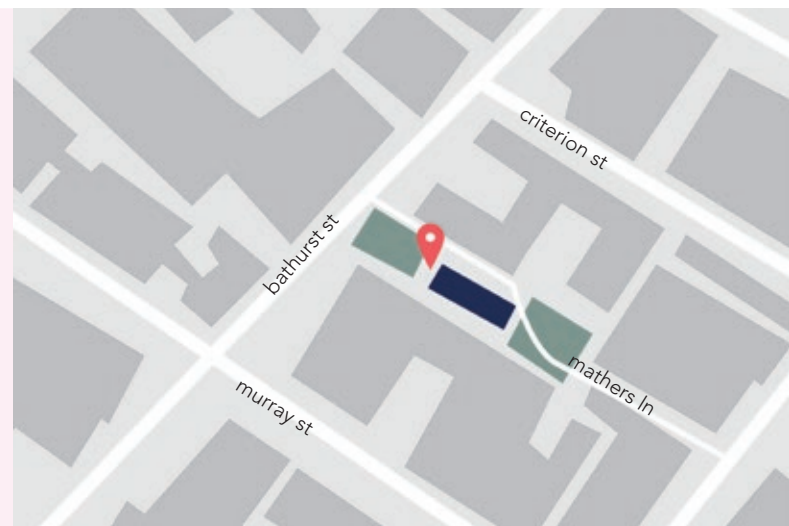
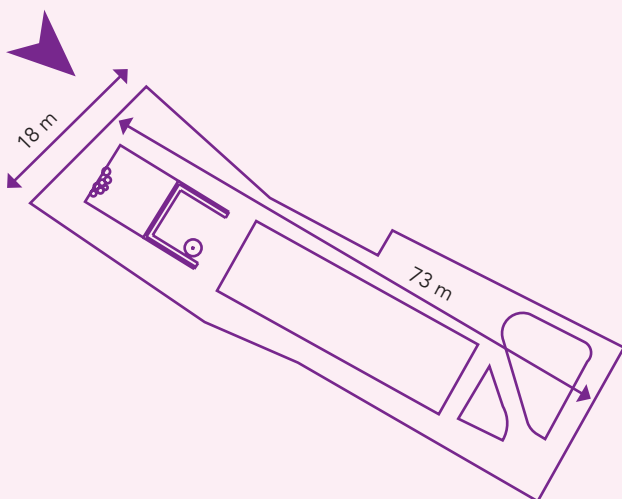



MAWSON'S PLACE CAR PARK

CREATIVE USES



DESCRIPTION

Situated between Mawson's place and the Hobart tourist info centre, the site serves as a gateway from the city to the cove along the heavily beaten Elizabeth Street pavements. The site is enclosed on the North and South boundaries with prominent Street exposure to the West and views through to Victoria Dock on the East. Being adjacent to constitution dock, Mawson's Hut, Elizabeth Street Pier and Franklin Wharf the site is amongst the action over the summer festival period. This location would be ideal for musical performances, light installations, roving performances, craft markets, food vans, creative community projects and events.

SPECIAL FEATURES

Forgotten gem situated between Hobart's CBD and Salamanca.

 UNIVERSAL ACCESS: YES

M²: ~800

LOCATION

1-3 Elizabeth St,
Hobart, Tasmania, 7000

CONNECTIONS

Mawson's Hut
Salamanca
CBD
Hunter Street
TMAG

TRANSPORT



KEY INFORMATION

LARGEST OPENING	N/A
CEILING HEIGHT	N/A
FLOORING TYPE	Concrete
STREET PROMINENCE	High

**CREATIVE
HOBART**

AN INITIATIVE OF

City of HOBART



VENUE STATS



CAPACITY	500+
UNIVERSAL ACCESS	Yes
TOILETS	No
EGRESS	3 x Exits
BACK OF HOUSE	No
CATERING FACILITIES	No
HEATING	No
STORAGE	No
FURNITURE	No
PARKING	Metered street parking
FOOD VAN ACCESSIBILITY	Yes, via Elizabeth St only
OUTDOOR SPACE	Yes
COST – FEES & CHARGES	Case by case basis
ABILITY TO BLACKOUT LIGHT	No
FLOOR TYPE	Uneven concrete
STAGE	No

LIGHTING	No
ACOUSTIC QUALITY	Poor
AMBIENT NOISE ISSUES	Adjacent traffic
NOISE CONSIDERATIONS	No
POWER	No
PLACE OF ASSEMBLY LICENSE	May be required
LIQUOR LICENSE	May be required
CONTACT	Operations Manager - Car Parks
CONTACT NUMBER	(03) 6238 2773
CONTACT DIVISION	Parking Operations

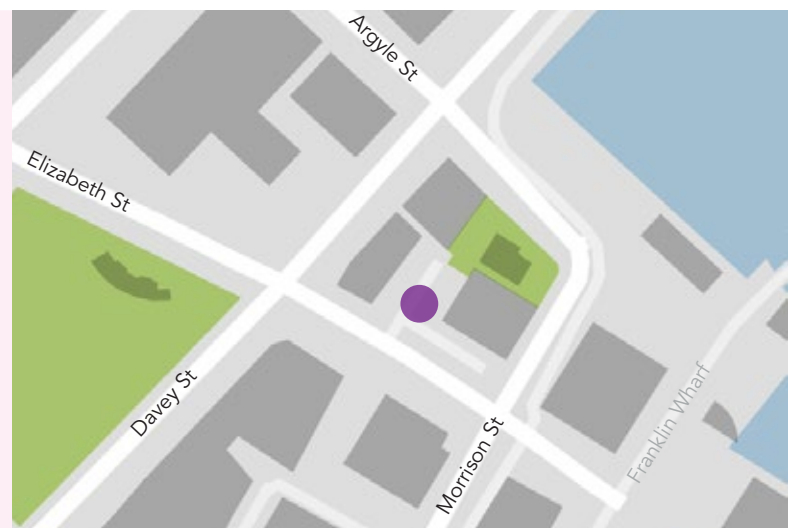
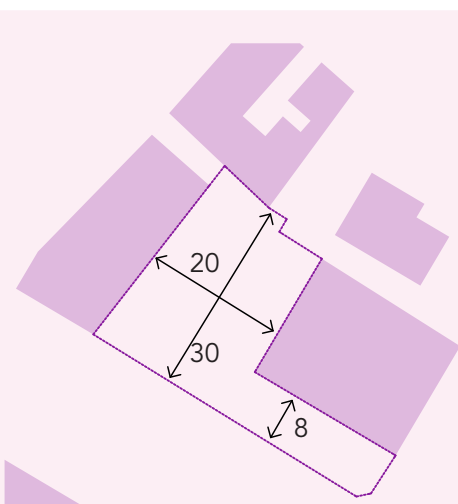



PRINCES PARK MAGAZINE

CREATIVE USES



DESCRIPTION

Underneath the popular Princes Park in Battery Point, a disused, fully intact subterranean magazine can be found. Surrounded by corridors, it still remains after the dismantling of the Mulgrave, Prince of Wales and Prince Albert Batteries in 1880. The vaulted sandstone corridors give the space great acoustic quality. The historical and atmospheric aesthetic favours light installations, small theatrical events and paired-back classical or contemporary music.

SPECIAL FEATURES

Historically rich, moody and surprising underground space.

 **UNIVERSAL ACCESS:** No

M²: 52

LOCATION

Castray Esplanade, Battery Point, Tasmania

CONNECTIONS

CBD
Salamanca
Hobart Waterfront
Inner city accommodation

TRANSPORT



KEY INFORMATION

LARGEST OPENING	1400W x 2100H
CEILING HEIGHT	3000
FLOORING TYPE	Even Dirt, sandstone.
STREET PROMINENCE	Low

**CREATIVE
HOBART**

AN INITIATIVE OF

City of **HOBART**



VENUE STATS



CAPACITY	Standing – 45, Seated – 15
UNIVERSAL ACCESS	No
TOILETS	Within 200m
EGRESS	1 x Exit
BACK OF HOUSE	Off Castray Esplanade
CATERING FACILITIES	No
HEATING	No
STORAGE	No
FURNITURE	None available on site
PARKING	Metered and unmetered street parking nearby
OUTDOOR SPACE	Yes
COST – FEES & CHARGES	Case by case basis
ABILITY TO BLACKOUT LIGHT	Yes
FLOOR TYPE	Even dirt and sandstone
STAGE	No

LIGHTING	Fluorescent uplights
ACOUSTIC QUALITY	Medium reverb
AMBIENT NOISE ISSUES	Adjacent traffic
NOISE CONSIDERATIONS	None
POWER	15 amp power
PLACE OF ASSEMBLY LICENSE	May be required
LIQUOR LICENSE	May be required
CONTACT	Parks administration
CONTACT NUMBER	03 6238 2886
CONTACT EMAIL	parks@hobartcity.com.au
CONTACT DIVISION	Park & City Amenity
RELEVANT LINKS	www.hobartcity.com.au/Community/Parks-reserves-and-sporting-facilities/Make-a-booking

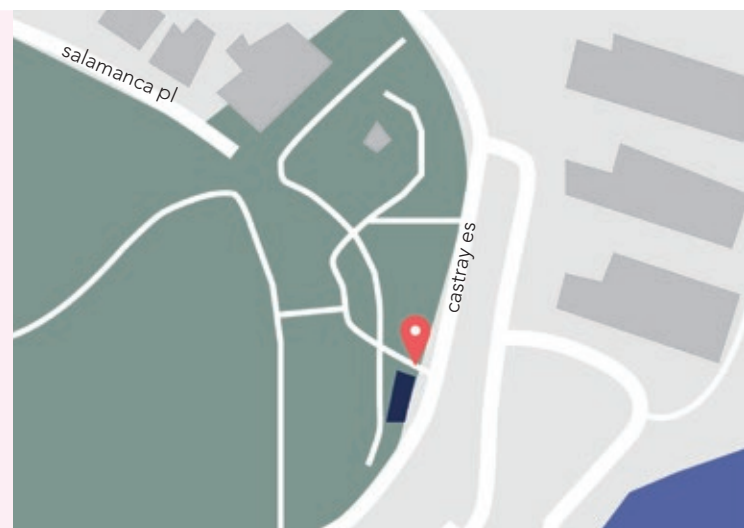
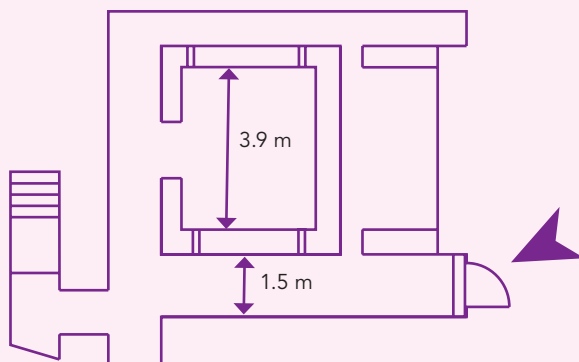



◀ QUEEN VICTORIA POWDER MAGAZINE

CREATIVE USES



M²: 100

LOCATION

Corner of Carriage Drive and Upper Domain Road

CONNECTIONS

CBD
Salamanca
Hobart Waterfront
Inner city accommodation

DESCRIPTION

The Queen of Victoria Powder Magazine contains a series of chambers designed to store gunpowder for the colony. Built in 1850, its location at the corner of Carriage Drive and Upper Domain Road within the Queens Domain allowed a safe distance from the colony to both safeguard the gunpowder from enemies and thieves and to protect the community from the volatile substance. The heritage listed sandstone, copper and brick magazine contains three vaulted chambers, one of these isolated from the rest. The elegant dimensions of the chambers along with its rich history help to provide the perfect space for small theatrical events, light, sound and projection installations, photography, meetings and book launches.

SPECIAL FEATURES

Beautiful vaulted ceilings and heritage gunpowder racks within a faceless sandstone complex.

 **UNIVERSAL ACCESS:** No

TRANSPORT



KEY INFORMATION

LARGEST OPENING 1060W x 2017H
CEILING HEIGHT 4700
FLOORING TYPE Timber
STREET PROMINENCE Low

**CREATIVE
HOBART**

AN INITIATIVE OF

City of **HOBART**



VENUE STATS



CAPACITY	Standing – 95, Seated – 50
UNIVERSAL ACCESS	No
TOILETS	Within 100m
EGRESS	1 x Exit
BACK OF HOUSE	Off Carriage Drive
CATERING FACILITIES	No
HEATING	No
STORAGE	Yes
FURNITURE	None available on site
PARKING	Off Carriage Drive and Cricket Ground (150m and walk)
OUTDOOR SPACE	Yes
COST – FEES & CHARGES	To be negotiated with lease-holder
LEASE HOLDER	Currently leased to SAA Military Collectors of Tasmania, a collecting and historic organisation. Subject to availability SAA takes bookings and arranges access to the venue.

ABILITY TO BLACKOUT LIGHT	Yes
FLOOR TYPE	Timber
STAGE	No
LIGHTING	Fluorescent tubes
ACOUSTIC QUALITY	High reverb, vaulted ceiling
AMBIENT NOISE ISSUES	Cricket and adjacent traffic
NOISE CONSIDERATIONS	None
POWER	Household standard
LIMITATIONS	Strictly no candles or other naked flame
PLACE OF ASSEMBLY LICENSE	May be required
LIQUOR LICENSE	May be required
CONTACT NAME	John Lennox
CONTACT NUMBER	0435 029 900
CONTACT EMAIL	jolona@netspace.net.au
RELEVANT LINKS	www.soldierswalk.org.au

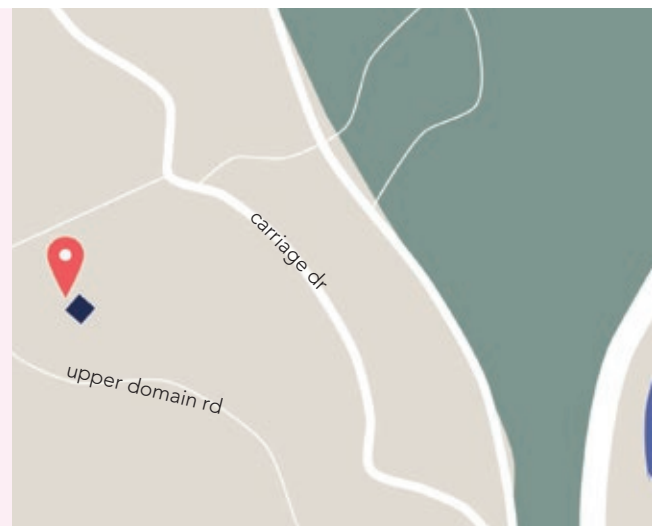
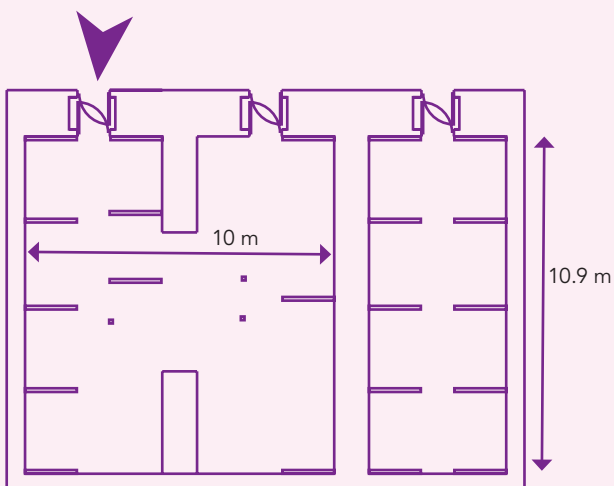



◀ RAILWAY ROUNDABOUT FOUNTAIN

CREATIVE USES

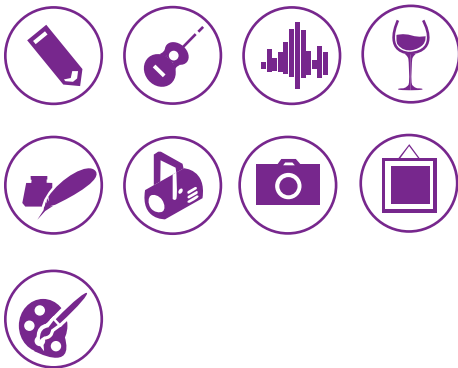

DESCRIPTION

Designed in 1963 as a competition entry by 3 engineering students who were employees of the Cadbury. After restoration works in 2012, the roundabout was named "world roundabout of the year" in 2015 by the International Roundabout Appreciation Society who were impressed by the dedication & inventiveness taken to restore Hobart's favorite roundabout. Restorations included, modern hydraulic & electrical systems & now features night displays where spray patters are back lit by alternating coloured lighting. The Railway Roundabout Fountain and surrounding tiered garden remains an important green-space refuge for city goers and links pedestrians between the city, Aquatic Centre, The Tennis Centre, Botanical Gardens, The Rose gardens, The Soldiers Memorial Ave and the University of Tasmania campus. This site provides the perfect location for light instillations, writing workshops, visual art workshops, creative community projects and roving performances.

SPECIAL FEATURES

Nestled within the urban fabric of Hobart's CBD.

 UNIVERSAL ACCESS: YES

M²: ~2300

LOCATION

Brooker HWY/Liverpool St,
Hobart, Tasmania, 7000

CONNECTIONS

CBD
Menzies
Rose Garden
Aquatic Centre
ABC

TRANSPORT



KEY INFORMATION

LARGEST OPENING	TBC
CEILING HEIGHT	2400
STREET PROMINENCE	Low

**CREATIVE
HOBART**

AN INITIATIVE OF

City of HOBART



VENUE STATS



CAPACITY	500 +
UNIVERSAL ACCESS	Yes - City Entry
TOILETS	No
EGRESS	2 x universal exits, 2 x stair exits
BACK OF HOUSE	No
CATERING FACILITIES	No
HEATING	No
STORAGE	No
FURNITURE	Perm. Seating for ~50pax
PARKING	Metered Street Parking + Multistory car parks
FOOD VAN ACCESSIBILITY	N/A
OUTDOOR SPACE	Yes
COST – FEES & CHARGES	Case by case basis
ABILITY TO BLACKOUT LIGHT	Yes (tunnels only)
FLOOR TYPE	Concrete + Grass
STAGE	No

LIGHTING	No
ACOUSTIC QUALITY	Possible high reverb issues
AMBIENT NOISE ISSUES	High level street traffic issues
NOISE CONSIDERATIONS	No
POWER	Yes
PLACE OF ASSEMBLY LICENSE	May be required
LIQUOR LICENSE	May be required
CONTACT	Parks administration
CONTACT NUMBER	(03) 6238 2886
CONTACT EMAIL	parks@hobartcity.com.au
CONTACT DIVISION	Parks & City Amenity Division
RELEVANT LINKS	www.hobartcity.com.au/Community/Parks-reserves-and-sporting-facilities

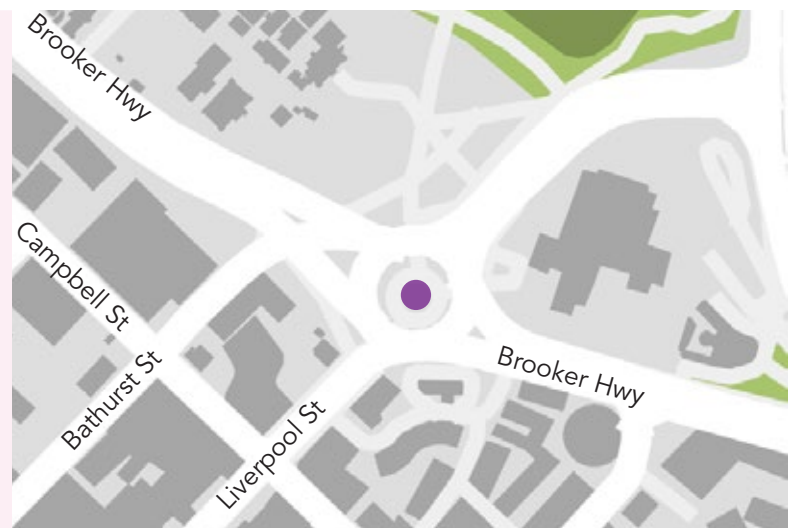
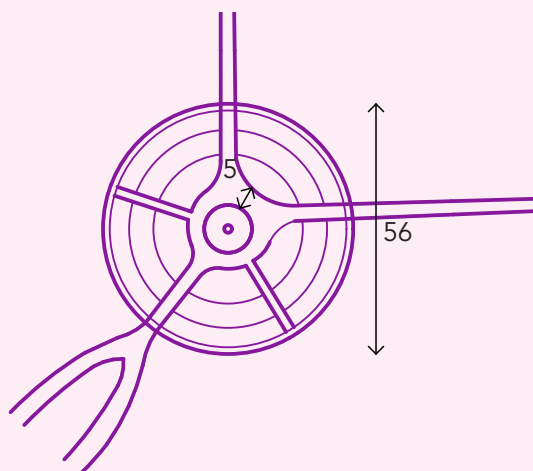



SANDY BAY SENIOR CITIZENS CLUB

CREATIVE USES



DESCRIPTION

Tucked away off Lambert Avenue, the Sandy Bay Citizens Club provides an ideal retreat within one of Hobart's prime residential areas. With a sprung timber floor the Citizens Club is one of the best venues in Hobart for dancing of all sorts. The high, open-trussed ceiling, stage and kitchen facilities also make this a great venue for workshops, recitals, industry award nights, master classes, book launches and other creative events.

SPECIAL FEATURES

Beautiful sprung timber dance floor

 **UNIVERSAL ACCESS:** Yes

M²: 300

LOCATION

23 Lambert Avenue, Sandy Bay, Tasmania

CONNECTIONS

CBD
Salamanca
Hobart Waterfront
Inner city accommodation

TRANSPORT



KEY INFORMATION

LARGEST OPENING	2010H x 840W
CEILING HEIGHT	4600
FLOORING TYPE	Sprung dancefloor
STREET PROMINENCE	Low

**CREATIVE
HOBART**

AN INITIATIVE OF

City of **HOBART**



VENUE STATS



CAPACITY	Standing – 200
UNIVERSAL ACCESS	Yes
TOILETS	3 x F, 3 x M, 1 x UAXS
EGRESS	4 x Exits
BACK OF HOUSE	Off Carpark
CATERING FACILITIES	Kitchen
HEATING	No
STORAGE	4,000 x 4,000
FURNITURE	Tables and chairs
PARKING	On-street and carpark
OUTDOOR SPACE	Yes
COST – FEES & CHARGES	Case by case basis. Limited Availability
ABILITY TO BLACKOUT LIGHT	No
FLOOR TYPE	Timber, sprung dance floor

STAGE	10000 x 4000
LIGHTING	Fluorescent
ACOUSTIC QUALITY	Low reverb, poor acoustics
AMBIENT NOISE ISSUES	No
NOISE CONSIDERATIONS	Residential area
POWER	Standard
PLACE OF ASSEMBLY LICENSE	Current license in place
LIQUOR LICENSE	May be required
CONTACT DETAILS	Club booking are managed by the lease holders
CONTACT NUMBER	Mark 0401 868 439
CONTACT EMAIL	pamela.welsh3@bigpond.com

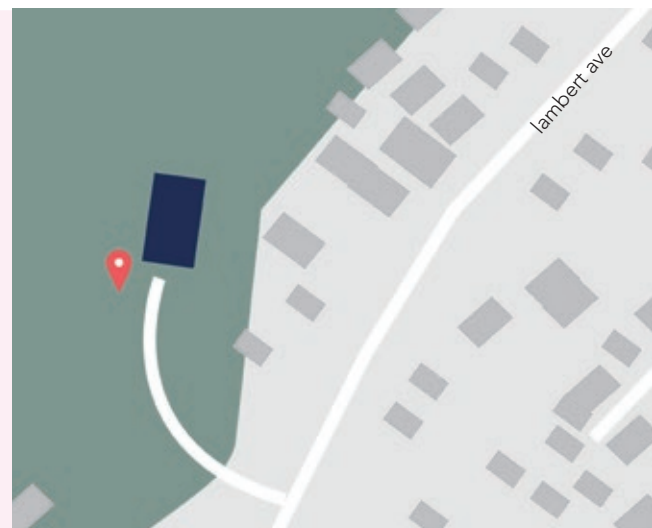
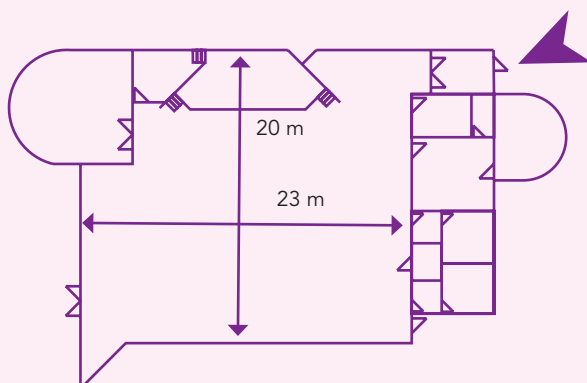



ST DAVIDS PARK ROTUNDA

CREATIVE USES



DESCRIPTION

In close proximity to both the waterfront and the city centre, the 1926 St. Davids Park Rotunda lies within a delightful inner city parkland of majestic trees and cured gardens. A former cemetery (1804- 1872) that was redeveloped in the 1920s, St. David's Park is a notable and popular outdoor area within Hobart and the site of many major events such as the annual Carols by Candlelight.

The rotunda lends itself towards musical performances, poetry readings and circus acts with removable ballastrading allowing for the use of scaffolding to create additional stage area.

SPECIAL FEATURES

Nestled within the beautiful landscape of St. David's Park.

 **UNIVERSAL ACCESS:** No

M²: 85

LOCATION

St Davids Park, Corner of Davey Street and Sandy Bay Road, Hobart, Tasmania 7000

CONNECTIONS

CBD
Salamanca
Hobart Waterfront
Battery Point
Inner city accommodation

TRANSPORT



KEY INFORMATION

LARGEST OPENING	10,00W x 1,800H
CEILING HEIGHT	4,500
FLOORING TYPE	Concrete
STREET PROMINENCE	Highly prominent within park.

**CREATIVE
HOBART**

AN INITIATIVE OF

City of **HOBART**



VENUE STATS



CAPACITY	Maximum 40 standing or seated
UNIVERSAL ACCESS	Not to stage
TOILETS	3 x 70m Uphill to park amenities
EGRESS	1 x Exit
BACK OF HOUSE/ PRODUCTION ACCESS	Salamanca Place and Sandy Bay Rd
CATERING FACILITIES	No
HEATING	No
STORAGE	No
FURNITURE	None available on site
PARKING	Metered street parking nearby
OUTDOOR SPACE	Yes
COST – FEES & CHARGES	Case by case basis
ABILITY TO BLACKOUT LIGHT	No
FLOOR TYPE	Concrete
STAGE	Venue is a stage

LIGHTING	Spotlights and stage lights
ACOUSTIC QUALITY	Noise projects to park
AMBIENT NOISE ISSUES	Adjacent traffic and park activity
NOISE CONSIDERATIONS	Residential and commercial zone
POWER	15-amp on-stage, 3-Phase under
PLACE OF ASSEMBLY LICENSE	May be required
LIQUOR LICENSE	Required
CONTACT	Parks administration
CONTACT NUMBER	03 6238 2886
CONTACT EMAIL	parks@hobartcity.com.au
CONTACT DIVISION	Park & City Amenity
RELEVANT LINKS	www.hobartcity.com.au/Community/Parks-reserves-and-sporting-facilities/Find-a-park-or-sportsground

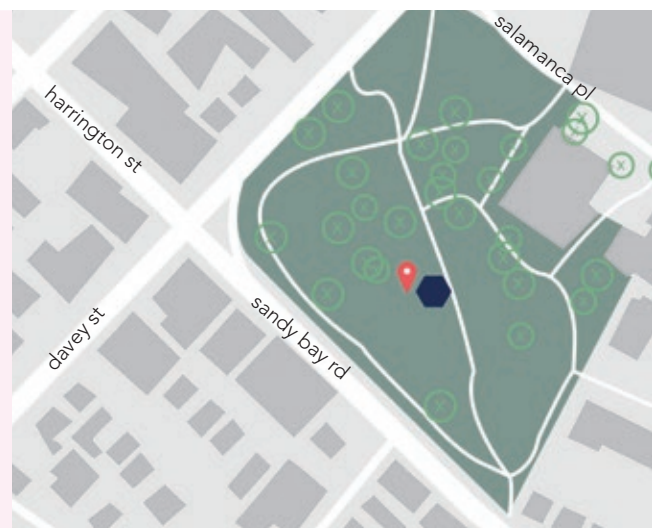
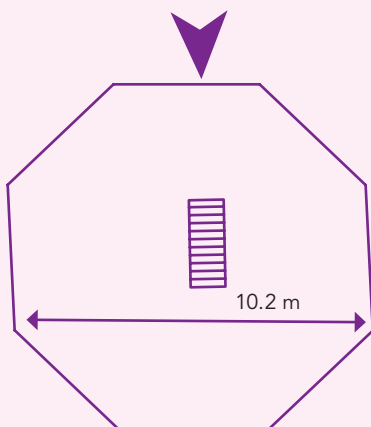



◀ TCA GROUND

CREATIVE USES



DESCRIPTION

Hosting the first recorded match in the cricket season of 1880/1881, the Tasmanian Cricket Association (TCA) ground is located on the hill of Queens Domain and offers visitors panoramic views over Hobart, the River Derwent and Kunanyi/Mount Wellington. The heritage listed crowd stands were variously built between 1880 and 1954.

Although the ground has hosted an AC/DC concert in the past with over 18,000 fans, these days it is a popular sports field with well maintained green spaces and is home to three local sports clubs.

With appropriate planning, the TCA could be a suitable venue for small-scale evening concerts, site-specific theatre and dance for intimate audiences, photography, performance and writing workshops and visual art installations.

SPECIAL FEATURES

Large sporting arena in close proximity to CBD.

 **UNIVERSAL ACCESS:** Entrance paths accessible. No equal access toilet on Council-managed property.

M²: ~3.4 HECTARES

LOCATION

Davies Ave,
Queens Domain, Tasmania, 7000

CONNECTIONS

CBD
Queen's Domain
Parliament House
City Hall
TMAG

TRANSPORT



KEY INFORMATION

LARGEST OPENING	N/A
CEILING HEIGHT	N/A
FLOORING TYPE	Turf
STREET PROMINENCE	High

**CREATIVE
HOBART**

AN INITIATIVE OF

City of **HOBART**



VENUE STATS



CAPACITY	8,000 If suitable safety plans implemented
UNIVERSAL ACCESS	Yes
TOILETS	Yes but not equal access
EGRESS	4 x exits
BACK OF HOUSE	No
CATERING FACILITIES	Kiosk
HEATING	No
STORAGE	No
FURNITURE	Tiered seating for 700
PARKING	100+ Spaces
FOOD VAN ACCESSIBILITY	Via main entry only
OUTDOOR SPACE	Yes
COST – FEES & CHARGES	Case by case basis
ABILITY TO BLACKOUT LIGHT	No
FLOOR TYPE	Curated turf and wicket

STAGE	No
LIGHTING	Yes
ACOUSTIC QUALITY	Open air
AMBIENT NOISE ISSUES	No
NOISE CONSIDERATIONS	Residential area within 100 metres.
POWER	Limited capacity suitable for sports use
PLACE OF ASSEMBLY LICENSE	Yes
LIQUOR LICENSE	Yes
CONTACT	Senior Administrative Officer
CONTACT NUMBER	03 6238 2885
CONTACT EMAIL	sportsgrounds@hobartcity.com.au
CONTACT DIVISION	Parks and City Amenity Division
RELEVANT LINKS	www.hobartcity.com.au/Community/Parks-reserves-and-sporting-facilities/Find-a-park-or-sportsground

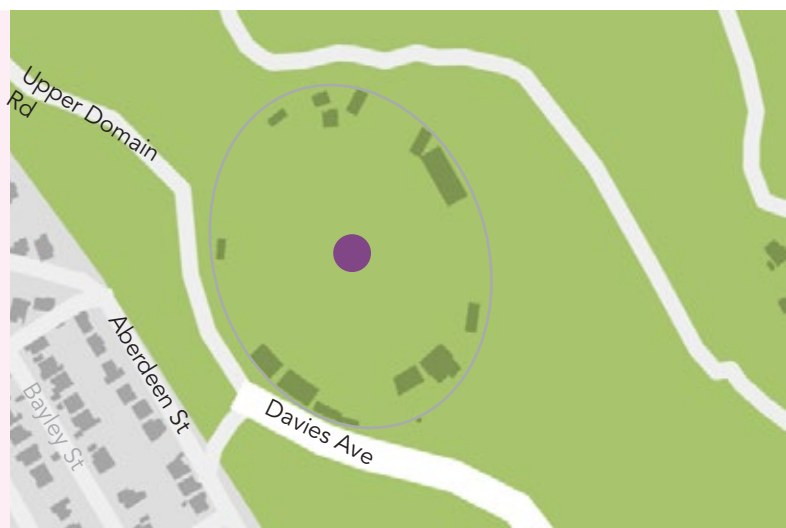
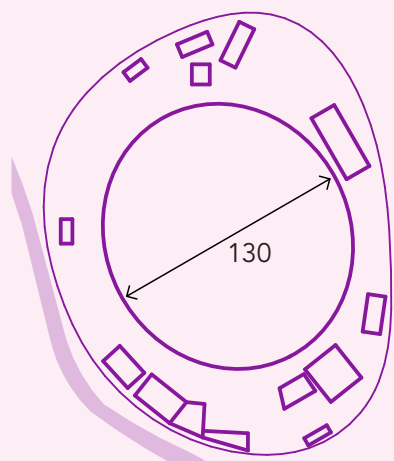



◀ THE DOONE KENNEDY HOBART AQUATIC CENTRE

CREATIVE USES



DESCRIPTION

The Doone Kennedy Hobart Aquatic Centre sits on the edge of the city and beginning of Hobart's Queen's Domain. The light, open interior space reveals this vast location with the backdrop of greenery flooding the trussed curvilinear space.

With a wide range of pool sizes available including an Olympic pool and leisure pool, as well as outdoor areas, this space offers a unique backdrop for creative theatre, dance and lighting installations in addition to creative aquatic ideas.

SPECIAL FEATURES

Impressive exposed structure and large grandstand style seating.

 **UNIVERSAL ACCESS:** Yes

M²: 4000⁽ⁱ⁾,700^(o)

LOCATION

1 Davies Avenue, Queens Domain

CONNECTIONS

CBD
Salamanca
Hobart Waterfront
Inner city accommodation

TRANSPORT



KEY INFORMATION

LARGEST OPENING	2100W x 4000H
CEILING HEIGHT	16000
FLOORING TYPE	Non slip tiles
STREET PROMINENCE	High

**CREATIVE
HOBART**

AN INITIATIVE OF

City of HOBART



VENUE STATS



CAPACITY	1:100 Lifeguard requirement, seated 850
UNIVERSAL ACCESS	Yes
TOILETS	14 x F, 7 x M, 6 x UAXS
EGRESS	10 x exits
BACK OF HOUSE	Off Aberdeen Street
CATERING FACILITIES	Cafe
HEATING	HVAC
STORAGE	Limited
FURNITURE	Grandstand & Cafe
PARKING	150+
OUTDOOR SPACE	Yes
COST – FEES & CHARGES	Variable depending upon usage
ABILITY TO BLACKOUT LIGHT	No
FLOOR TYPE	Non-slip tiles
STAGE	No

LIGHTING	Skylights, indirect surface luminers
ACOUSTIC QUALITY	High reverb
AMBIENT NOISE ISSUES	Adjacent traffic, public indoor pool
NOISE CONSIDERATIONS	None
POWER	Standard
PLACE OF ASSEMBLY LICENSE	May be required
LIQUOR LICENSE	Required
CONTACT PERSON	Customer Services & Events
CONTACT NUMBER	03 6222 6967
CONTACT DIVISION	Park & City Amenity
RELEVANT LINKS	www.hobartcity.com.au/Community/Doone-Kennedy-Hobart-Aquatic-Centre

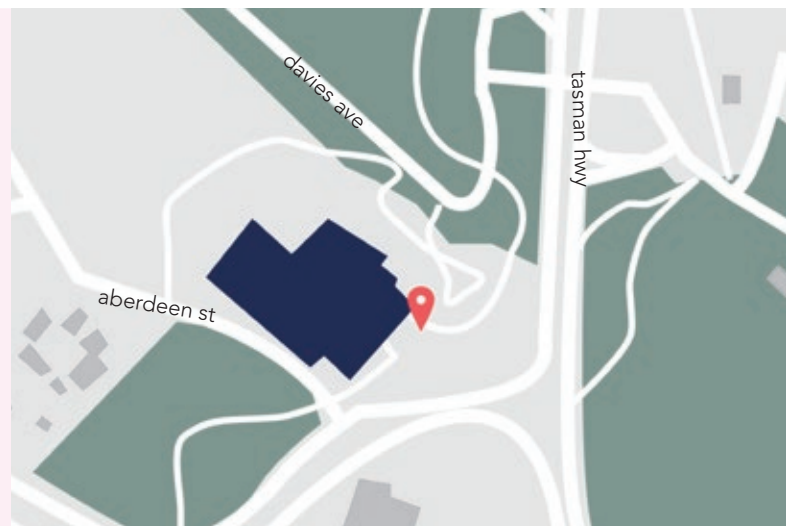
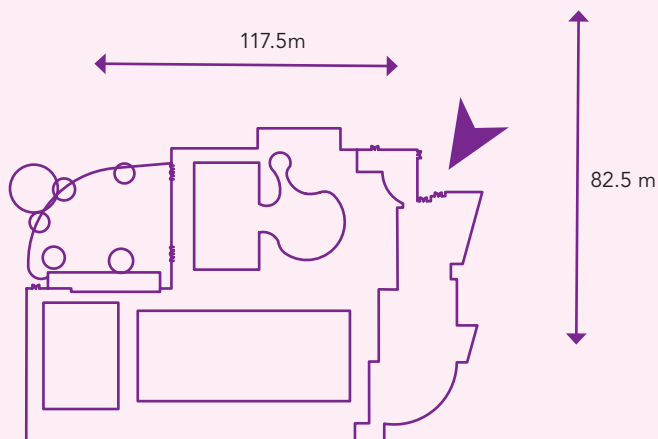



TOWN HALL

CREATIVE USES



DESCRIPTION

Experience the grandeur and the history of the magnificent Hobart Town Hall, the scene of many special occasions and events since 1866, including balls, wedding receptions, public meetings, floral festivals and concerts. The Town Hall auditorium seats up to 300 people and remains a popular and, unsurprisingly, conveniently central location for meetings, forums, presentations, fairs, performances, conventions and formal dinners for up to 130 people. Facilities include a basic public address system, kitchen facilities, level access, multiple seating arrangements, a Steinway grand piano and a magnificent, imposing piped organ that commands the room.

SPECIAL FEATURES

Grand staircase, ornate plaster mouldings and chandeliers.

 **UNIVERSAL ACCESS:** Yes

M²: 250

LOCATION

50 Maquarie Street Hobart
Tasmania 7000.

CONNECTIONS

CBD
Salamanca
Hobart Waterfront
Franklin Square
Tasmanian Museum + Art Gallery

TRANSPORT



KEY INFORMATION

LARGEST OPENING	21,00W x 3,200H
CEILING HEIGHT	9000
FLOORING TYPE	Timber Parquet
STREET PROMINENCE	High

**CREATIVE
HOBART**

AN INITIATIVE OF

 City of HOBART



VENUE STATS



CAPACITY	Standing – 300, Seated – 300
UNIVERSAL ACCESS	Yes
TOILETS	F x 4, 1 x M, 2 x UAXS
EGRESS	2 x Exits
BACK OF HOUSE	Access off Macquarie Street
CATERING FACILITIES	Kitchen
HEATING	Oil heaters along wall
STORAGE	Minimal
FURNITURE	Multiple seating arrangements. Some trestles available.
PARKING	Metered street parking nearby
OUTDOOR SPACE	No
COST – FEES & CHARGES	\$95/hr-\$2,350/wk. Various rates.
ABILITY TO BLACKOUT LIGHT	No
FLOOR TYPE	Timber parquet
STAGE	9,800 x 3,400

LIGHTING	Chandeliers x 3, Stage Downlights & Fluoro Uplights
ACOUSTIC QUALITY	Low reverb.
AMBIENT NOISE ISSUES	Adjacent traffic
NOISE CONSIDERATIONS	Adjacent offices
POWER	8 x Standard outlets
PLACE OF ASSEMBLY LICENSE	Current License in place
LIQUOR LICENSE	Service of liquor licence included in hire
CONTACT NAME	Hallkeeper
CONTACT NUMBER	03 6238 2765
CONTACT EMAIL	hallbookingenquiries@hobartcity.com.au
CONTACT DIVISION	Corporate Services
RELEVANT LINKS	www.hobartcity.com.au/Community/Venues-banners-and-signage/Halls-and-venues

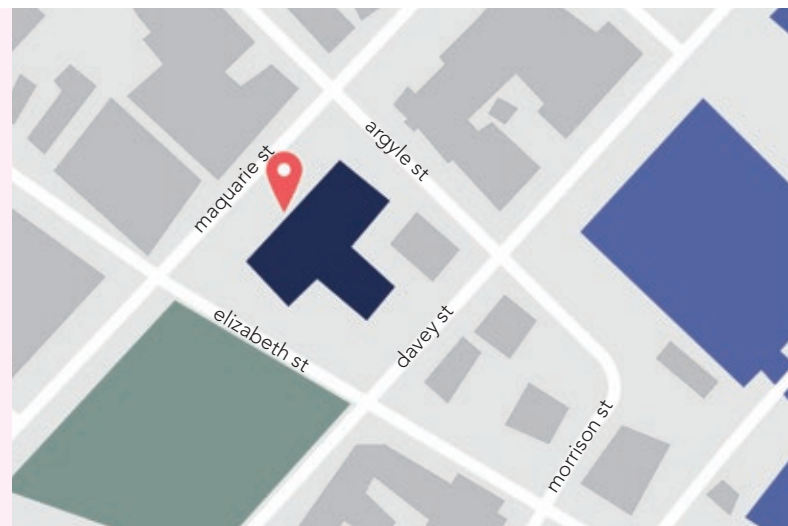
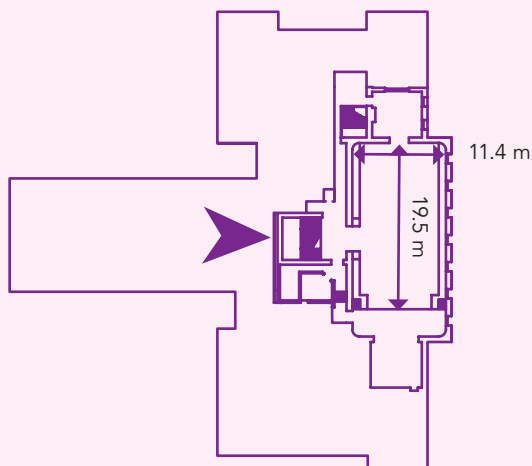



◀ TOWN HALL UNDERGROUND

CREATIVE USES



DESCRIPTION

Under the grandeur of the historic Hobart Town Hall is a hidden, rustic treasure. Known as "The Underground" it comprises a hallway and four rooms, including the ex-constable's room. At the height of its use, the rooms were connected by a tight staircase to the Town Hall Courtroom above.

The Underground offers an interestingly raw backdrop for small creative events such as installations, contemporary music, performance installations, sculpture exhibitions, a gallery space, or eerie book launches and poetry readings.

SPECIAL FEATURES

Eclectic pathwork of bricks, paint and exposed wooden bearers.

 **UNIVERSAL ACCESS:** Yes. Uneven surface.

M²: 130

LOCATION

16 Argyle street Hobart,
Tasmania 7000

CONNECTIONS

CBD
Salamanca
Hobart Waterfront
Tasmanian Museum & Art Gallery
Franklin Square

TRANSPORT



KEY INFORMATION

LARGEST OPENING	2010H x 1280W
CEILING HEIGHT	2300-2650
FLOORING TYPE	Concrete, uneven + rough.
STREET PROMINENCE	Low.

**CREATIVE
HOBART**

AN INITIATIVE OF

City of HOBART



VENUE STATS



CAPACITY	Standing – 120, Seating – 60
UNIVERSAL ACCESS	Yes - uneven surface
TOILETS	No, 50m to Franklin Square amenity
EGRESS	2 x Exits (1 x universally accessible)
BACK OF HOUSE	Entry via Elizabeth Street (Town Hall carpark)
CATERING FACILITIES	No
HEATING	No
STORAGE	No, but potential to use Town Hall residency
FURNITURE	None available on site
PARKING	Metered street parking nearby
OUTDOOR SPACE	No – small courtyard & parking deck after hours
COST – FEES & CHARGES	Case by case basis
ABILITY TO BLACKOUT LIGHT	Yes

FLOOR TYPE	Concrete, uneven, rough
STAGE	No
LIGHTING	Fluorescent
ACOUSTIC QUALITY	Low reverb
AMBIENT NOISE ISSUES	Adjacent traffic
NOISE CONSIDERATIONS	Offices above
POWER	14 x Standard powerpoints
PLACE OF ASSEMBLY LICENSE	May be required
LIQUOR LICENSE	May be required
CONTACT NAME	Jo Duffy
CONTACT NUMBER	03 6238 2778
CONTACT EMAIL	duffyj@hobartcity.com.au
CONTACT DIVISION	Community Development

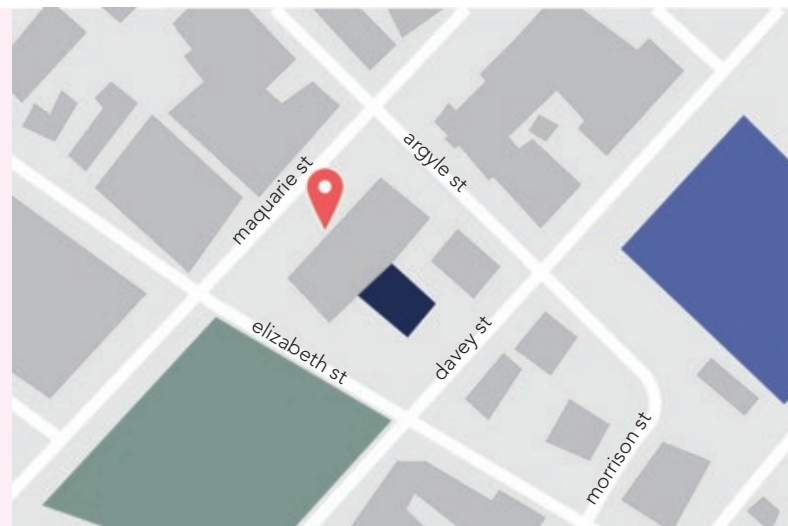
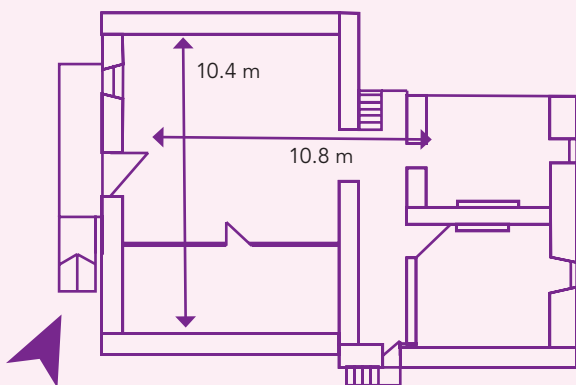



◀ WATERWORKS RESERVE

CREATIVE USES

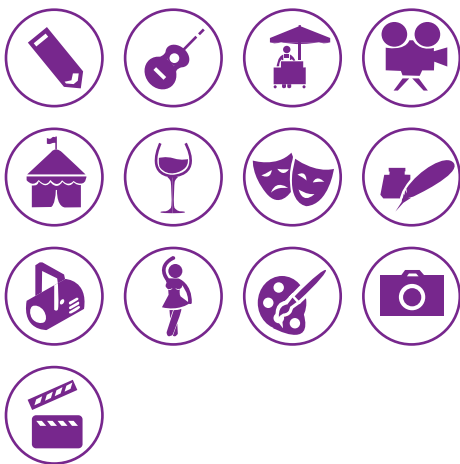

DESCRIPTION

First developed in the 1860's, the waterworks reservoir captures the flow of creeks and rivers rising on the higher slopes of Mt Wellington. Flowing via a network of stone and timber troughs and channels, the gathered waters arrived at the receiving house, where today, an informative display explains the curious history of this important and historic site.

There a number of different sites available. Tree shaded lawns and childrens' play areas of the waterworks are popular for picnics and barbeques and also provide the perfect backdrop for light installations, creative community events, poetry readings, photography, musical performances, painting and drawing workshops and theatrical performances.

SPECIAL FEATURES

A wide variety of useable spaces in a picturesque setting.

 **UNIVERSAL ACCESS:** Yes, site dependant.

LOCATION

Waterworks Road, South Hobart, Tasmania, 7054

CONNECTIONS

Visual links to Mt Wellington

TRANSPORT



KEY INFORMATION

LARGEST OPENING	N/A
CEILING HEIGHT	N/A
FLOORING TYPE	Grass, paths defined.
STREET PROMINENCE	Prominent entrance.

**CREATIVE
HOBART**

AN INITIATIVE OF

 City of **HOBART**



VENUE STATS



CAPACITY	Large open park – Numbers vary for each site
UNIVERSAL ACCESS	Yes - site dependant
TOILETS	5 x F, 3 x M, 1 x UAXS
EGRESS	1 x Exit to Waterworks Road
BACK OF HOUSE	Road access to most areas
CATERING FACILITIES	BBQ
HEATING	No
STORAGE	No
FURNITURE	Park furniture
PARKING	70 Spaces
OUTDOOR SPACE	Yes
COST – FEES & CHARGES	Case by case basis
ABILITY TO BLACKOUT LIGHT	No
FLOOR TYPE	Grass, path defined
STAGE	No

LIGHTING	No
ACOUSTIC QUALITY	Open Space
AMBIENT NOISE ISSUES	No
NOISE CONSIDERATIONS	Isolated Area
POWER	None
PLACE OF ASSEMBLY LICENSE	Current License in place
LIQUOR LICENSE	May be required
CONTACT	Parks administration
CONTACT NUMBER	03 6238 2886
CONTACT EMAIL	parks@hobartcity.com.au
CONTACT DIVISION	Park & City Amenity
RELEVANT LINKS	www.hobartcity.com.au/Recreation/Bushland/Waterworks_Reserve





◀ WATERSIDE PAVILION

CREATIVE USES



DESCRIPTION

Originally a dockside workers complex, the Waterside Pavilion has been redefined as an attractive, contemporary venue located in the heart of Hobart’s fascinating waterfront district. Waterside Pavilion has a strong connection to Constitution Dock, providing ample opportunity to flow out and congregate outside, where there is affiliated landscaping and street furniture, including seats, windguards and lighting.

Whilst maintaining some of the brickwork exterior of the original harbour building, extensive glazing floods the interior of the pavilion with natural light, as well as capturing key views of its surrounds. The space offers dual level, polished hardwood floors and spectacular glulam portal frames. A kitchenette and bathroom facilities are available, which are all discreetly hidden from view.

SPECIAL FEATURES

Glazing lights up like a lantern at night.

 **UNIVERSAL ACCESS:** Yes

M²: 200

LOCATION

Mawson Place,
Argyle St Hobart, Tasmania 7000

CONNECTIONS

CBD
Salamanca
Hobart Waterfront
Mawsons Hut
Inner city accommodation

TRANSPORT



KEY INFORMATION

LARGEST OPENING 2000W x 2050H
CEILING HEIGHT
FLOORING TYPE Timber
STREET PROMINENCE High

**CREATIVE
HOBART**

AN INITIATIVE OF

City of HOBART



VENUE STATS



CAPACITY	Standing – 100, Seated – 100
UNIVERSAL ACCESS	Yes – all entries
TOILETS	3 x F, 2 x M, 1 x UAXS, 1 x Baby-change
EGRESS	5 x Exits
BACK OF HOUSE	Flat sealed access
CATERING FACILITIES	Small kitchenette
HEATING	10 x Radiant panels
STORAGE	Minimal: .5 x 1.2 storage rooms x 2
FURNITURE	None available on site
PARKING	3 Loading space permits and metered street parking nearby
OUTDOOR SPACE	Yes but limited, wharf area owned by Tasports
COST – FEES & CHARGES	Commercial \$160/hr-\$2,300/wk Non-commercial \$80/hr-\$1,150/wk
ABILITY TO BLACKOUT LIGHT	No
FLOOR TYPE	Timber

STAGE	No
LIGHTING	Wall uplights, ceiling track-lights
ACOUSTIC QUALITY	High reverb, despite acoustic panels
AMBIENT NOISE ISSUES	Davey Street traffic and dockside activity
NOISE CONSIDERATIONS	Non-residential, night-life area
POWER	12 x Standard power points
PLACE OF ASSEMBLY LICENSE	Current license in place
LIQUOR LICENSE	May be required
CONTACT NAME	Hallkeeper
CONTACT NUMBER	03 6238 2765
CONTACT DIVISION	Corporate Services
RELEVANT LINKS	www.hobartcity.com.au/Community/Venues-banners-and-signage/Halls-and-venues

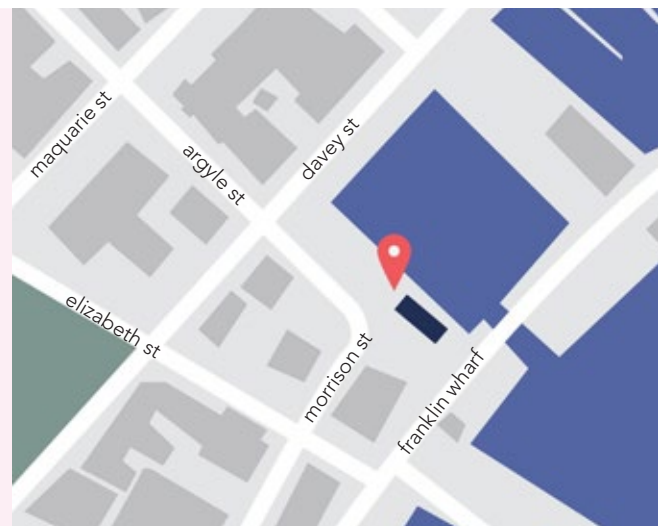
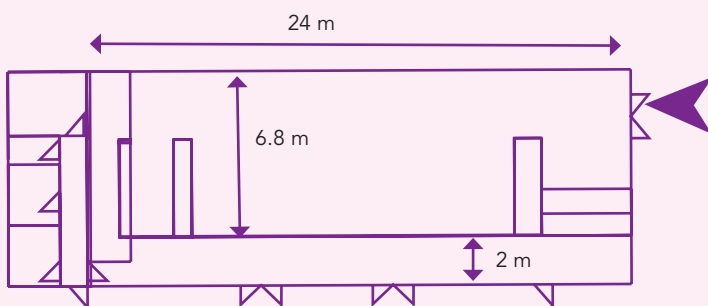



YOUTH ARTS & RECREATION CENTRE

CREATIVE USES



M²: 330

LOCATION

44 Collins Street Hobart,
Tasmania 7000

CONNECTIONS

CBD
Salamanca
Hobart Waterfront
Inner city accommodation

DESCRIPTION

Originally part of Hobart's majestic City Hall, this converted warehouse space has been used for a diverse range of activities, most curiously a drive-through green grocer.

The building now focuses on more creative community activities and caters for up to 225 people with a range of facilities, including an art studio, art gallery walls, music studio, kitchen, versatile recreation space, a recording studio, and performance stage with a public address system. The Centre - commonly called Youth ARC - is the perfect venue for youth-orientated cultural and creative projects such as visual arts, dance and music events.

SPECIAL FEATURES

Exposed timber rafters and a large warehouse volume with saw tooth roof.

 **UNIVERSAL ACCESS:** Yes

TRANSPORT



KEY INFORMATION

LARGEST OPENING	Commercial roller door
CEILING HEIGHT	3800
FLOORING TYPE	Carpet, lino + asphalt
STREET PROMINENCE	High

**CREATIVE
HOBART**

AN INITIATIVE OF

City of **HOBART**



VENUE STATS



CAPACITY	Standing – 225, Seated – 115
UNIVERSAL ACCESS	Yes
TOILETS	2 x M, 3 x F, 1 x UAXS
EGRESS	2 x Exits
BACK OF HOUSE	Via Market Place
CATERING FACILITIES	Kitchenette
HEATING	Yes
STORAGE	No
FURNITURE	Yes
PARKING	Metered street parking nearby
OUTDOOR SPACE	No
COST – FEES & CHARGES	Commercial \$250-\$300/hr, Non-commercial \$36-\$50/hr. Minimum hire 4 hours.
ABILITY TO BLACKOUT LIGHT	No
FLOOR TYPE	Carpet, lino, asphalt
STAGE	6,000 x 4,800 mm

LIGHTING	Fluorescent tubes and track-light + 1 rigging point
ACOUSTIC QUALITY	High reverb, double height area
AMBIENT NOISE ISSUES	City Hall, Youth Arc Rehearsal Room
NOISE CONSIDERATIONS	City Hall, Youth Arc Rehearsal Room
POWER	3-Phase and standard
PLACE OF ASSEMBLY LICENSE	Current license in place
LIQUOR LICENSE	Drug & Alcohol Free Venue
CONTACT NAME	Youth Programs Team Leader
CONTACT NUMBER	03 6231 5150
CONTACT EMAIL	youthartsandrec@hobartcity.com.au
CONTACT DIVISION	Community Development
RELEVANT LINKS	www.hobartcity.com.au/ Community/Venues-banners- and-signage/Halls-and-venues

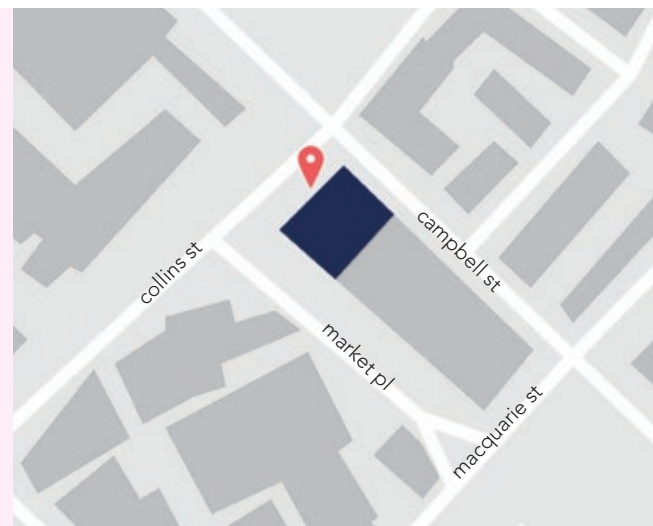
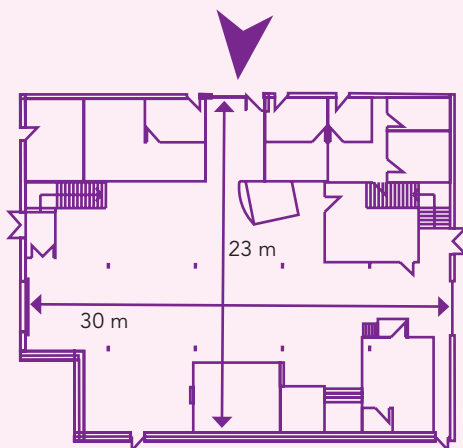



◀ YOUTH ARTS REHEARSAL ROOM

CREATIVE USES



DESCRIPTION

Attached to Hobart's City Hall in a previous life, this second story venue now forms part of the Youth Arts & Recreation Centre. It has been converted into a funky studio and adjoining classroom. The large room is well lit, featuring a saw tooth roof and mirrored walls and is well suited to creative events such as dance, theatre, music and creative industry events. Once connected to City Hall, the venue can also be used as a greenroom space for stage performances next door.

SPECIAL FEATURES

Ample natural light.

 **UNIVERSAL ACCESS:** No

M²: 220

LOCATION

44 Collins Street
Hobart, Tasmania 7000

CONNECTIONS

CBD
Salamanca
Hobart Waterfront
Inner city accommodation

TRANSPORT



KEY INFORMATION

LARGEST OPENING	1200W x 2010H
CEILING HEIGHT	3800
FLOORING TYPE	Timber
STREET PROMINENCE	High

**CREATIVE
HOBART**

AN INITIATIVE OF

City of HOBART



VENUE STATS



CAPACITY	Standing – up to 100
UNIVERSAL ACCESS	No
TOILETS	5 x F, 2 x M
EGRESS	2 x Exits
BACK OF HOUSE	Off Market Place
CATERING FACILITIES	No
HEATING	No
STORAGE	No
FURNITURE	None available on site
PARKING	Metered street parking and multi-storey carpark nearby
OUTDOOR SPACE	No
COST – FEES & CHARGES	\$50/hr. Limited availability.
ABILITY TO BLACKOUT LIGHT	No
FLOOR TYPE	Timber

STAGE	No
LIGHTING	Fluorescent tubes
ACOUSTIC QUALITY	High reverb
AMBIENT NOISE ISSUES	Adjacent traffic, CBD, city hall, youth arc
NOISE CONSIDERATIONS	City Hall, Youth ARC, residential
POWER	Standard
PLACE OF ASSEMBLY LICENSE	May be required
LIQUOR LICENSE	Drug & Alcohol Free Venue
CONTACT NAME	Youth Programs Team Leader
CONTACT NUMBER	03 6231 5150
CONTACT EMAIL	youthartsandrec@hobartcity.com.au
CONTACT DIVISION	Community Development
RELEVANT LINKS	www.youthartsandrec.org/

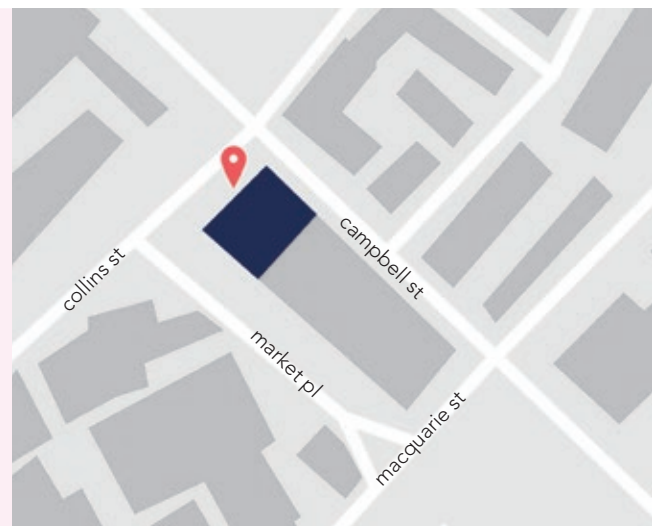
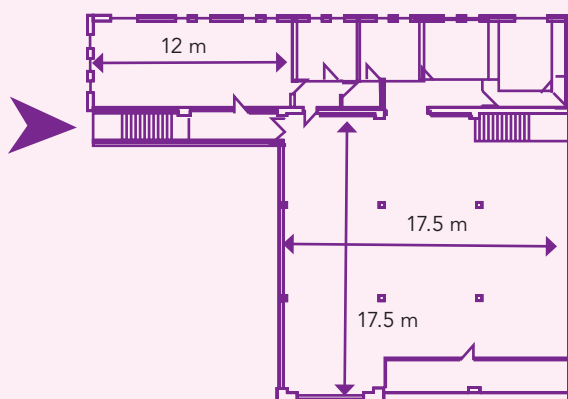

FURTHER INFO.

TEMPORARY OCCUPANCY PERMIT

The building legislation of Tasmania specifies that certain types of temporary structures/buildings require a temporary occupancy permit prior to their usage. During the planning phase of your event or activity, it is recommended that you contact the person listed on the relevant page of this guide to see if you will need to obtain a temporary occupancy permit. Permits may take 2 - 3 weeks to process once all of the paperwork is submitted to the Council.

Tents and marquees may incur a site marking fee of up to \$325 when erected in Council parks. Contact the person nominated for the parkland, to check if this will apply.

Exemptions for Temporary Occupancy exist for tents and marquees if:

- The structure measures under 75 m² in floor space.
- The venue does not have an ignitable fuel source.
- The structure is not in use for more than two days.

FURTHER INFORMATION

www.thelaw.tas.gov.au/tocview/content/w3p;cond=;doc_id=%2B43%2B2004%2BGS38@EN%2B20061025000000;histon=;inforequest=;prompt=;rec=48;term=

APPLICATION FORMS

www.hobartcity.com.au/files/95f8604c-70ff42d8-b580-9d2200a578ce/application_for_temporary_occupancy_permit.pdf

PLACE OF ASSEMBLY LICENCE

If you anticipate over 1,000 people at your outdoor event, a Place of Assembly Licence is required. An application fee is \$150 if lodged 10 days or more prior to event, and \$250 if lodged less than 10 days to event.

FURTHER INFORMATION

www.hobartcity.com.au/Business/Place-of-assembly-licences

APPLICATION FORM

www.hobartcity.com.au/files/assets/public-public-health/place-of-assembly-licence-application-form.docx

LIQUOR LICENCE

Permits are required for the consumption of alcohol on all Council-owned land. Council reserves the right to refuse any application it receives.

Further information:

www.treasury.tas.gov.au/domino/DTF/DTF.nsf/6044ee0c-1cf958a2ca256f2500108bba/5d29d029bbb08d5fca257d820017721c?OpenDocument

As required by Section 25 of the Police Offences Act 1935 the Council, in conjunction with Tasmania Police, has declared some parks as public places, thus restricting the consumption of alcohol.

The regulations restrict alcohol possession and consumption in the following areas of Hobart:

www.hobartcity.com.au/Community/Parks-reserves-and-sporting-facilities/Consumption-of-alcohol

LOCATION	RESTRICTION
Franklin Square	24 hours, 7 days a week
Salamanca Lawns	10 December - 1 January, 3pm - 10am 2 January - 9 December, 10pm - 10am
Princes Park	8pm to 8am, 7 days a week
Parliament House Gardens	10 December - 1 January, 3pm - 10am 2 January - 9 December, 10pm - 10am
North Hobart Cultural & Skate Park	24 hours, 7 days a week
St David's Park	24 hours, 7 days a week
John Doggett Park	8pm to 8am, 7 days a week
Soundy Park	8pm to 8am, 7 days a week
Hobart Regatta Grounds	8pm to 8am, 7 days a week
Hobart Rivulet Linear Park	8pm to 8am, 7 days a week
The University Rose Gardens	8pm to 8am, 7 days a week
Hobart Cenotaph	8pm to 8am, 7 days a week
Long Beach Reserve	24 hours, 7 days a week (within fenced area of playground only)

HOBART CITY COUNCIL FEE & CHARGES BOOKLET

For more information about fees and charges to use Council-owned venues, refer to the latest Council booklet at www.hobartcity.com.au/Council/Fees-and-charges

ACKNOWLEDGMENTS

The City of Hobart would like to thank Pip Grainger and Clare McLaine for the significant contribution they made to this Guide during their UTAS School of Architecture/City of Hobart internship.